

CHELIC[®]

PNEUMATIC

氣立可 氣動設備

I-I 版

CAT-I803



二口二位電磁閥型錄

2 PORTS SOLENOID VALVE SERIES



台灣氣立股份有限公司
[http : // www.chelic.com](http://www.chelic.com)

二口二位電磁閥

2 PORTS SOLENOID VALVE



SBS Series

P.8

直動式 / 不鏽鋼本體

Direct operated / Stainless steel body

▶ 產品特點 Features

適用於空氣、水及蒸氣

Suitable for the fluid of air, steam and water.



SU Series

P.9

直動式 / PPS 塑膠本體

Direct operated / PPS Body

▶ 產品特點 Features

適用於空氣、水及真空

Suitable for the fluid of air, water and vacuum.



SFW Series

P.14

小型直動式 / PPS 塑膠本體

Direct operated / PPS Body

▶ 產品特點 Features

適用於空氣、水及真空

Suitable for the fluid of air, water and vacuum.



SUB Series

P.23

小型直動式 / 銅本體

Small direct operated / Brass body

▶ 產品特點 Features

適用於空氣

Suitable for the fluid of air.



SUG Series

P.29

小型直動式 / 銅本體

Small direct operated / Brass body

▶ 產品特點 Features

適用於空氣、水及油

Suitable for the fluid of air, water and oil





SUD2 Series

P.16

直動式 / 銅本體

Direct operated / Brass body

產品特點 Features

適用於空氣、水、油及蒸氣

Suitable for the fluid of air, water, light oil and steam.



SUW2 Series

P.17

直動式 / 銅本體

Direct operated / Brass body

產品特點 Features

適用於空氣、水及油

Suitable for the fluid of air, water and light oil.



SUS Series

P.18

直動式 / 銅本體

Direct operated / Brass body

產品特點 Features

適用於空氣、水、蒸氣及輕油

Suitable for the place of steam, light oil, steam and air.



SAS Series

P.19

直動膜片式 / 不鏽鋼本體

Direct diaphragm / Stainless steel body

產品特點 Features

適用於空氣、水及蒸氣

Suitable for the fluid of air, steam and water.

SDC Series

P.21

直動膜片式 / 鐵氟龍閥體耐強酸鹼用

Direct diaphragm / Teflon niumenon can bear the strong acid and alkai

產品特點 Features

適用於酸鹼性及腐蝕性之流體

Teflon niumenon can bear the strong acid and alkai.

可使用流體識別圖 Used of fluid identification items



空氣



真空



輕油



蒸氣





水

安全須知 / 注意事項 ① Safety notice / Common caution



使用前必須閱讀本 "安全須知"，為使您在使用本公司產品前，注意之安全事項，為了預防對人體之傷害及財產設備之損壞；因此，按照預防之程度，分為 "危險"，"警告"，及 "注意" 三種類別。

Please read this safety notice carefully, pay attention to safety item while using this product, in order to prevent injury to human body and damage of property; thus, there are divided into three classes of "Danger", "Warning", and "Caution" according to the extend of prevention.

 危險 Danger	<p>明顯位於 "危險" 狀態，不迴避即有可能致人死亡或重傷；必須特別之安全防護及管理，避免 "危險" 發生。</p> <p>Obvious situated at "Danger" state, may cause casualty if not avoided; take special safety protection and management to prevent the occurrence of "Danger"</p>
 警告 Warning	<p>使用之狀況，處於 "危險" 狀態不迴避即有可能致人死亡或重傷；必須特別之安全防護及管理，避免 "危險" 發生。</p> <p>Condition of operation is situated at "Warning" state, may cause casualty if not avoided; take special safety protection and management to prevent the occurrence of "Warning"</p>
 注意 Caution	<p>使用之狀況，處於 "危險" 狀態，不迴避即有可能致人負輕傷或中程度傷害，而且有可能損壞設備及財物；必須注意安全防護及管理。</p> <p>Condition of operation is situated at "Caution" state, may cause minor or moderate injury and damage of property if not avoided; take special safety protection and management.</p>

- 安全維護及事故之防止，請於使用本公司產品前，必須明白使用條件及充分了解設計、安裝、使用之程序及必要之安全條件。

For safety protection and prevention of accident, please understand the condition of application and know the design, installation, procedure of usage and essential safety condition before using this product.

- 請依產品之規格規範以內使用；超越規範以外之條件使用，會造成危險的。

如果是特殊之使用條件，必須考慮到安全性之確認，才可以使用；在閱讀資料及相關資訊若有若有疑慮，在未使用前，須與本公司聯絡與洽詢。

Please use within the specification and requirement of this product; application beyond the specification may cause hazard. In case of special condition of application, take the confirmation of safety into account and then use it; in case of doubt in reading this information and related data, contact us before using.

- 壓縮空氣及附屬設備，其組裝及操作錯誤是有危險的；所以選用產品時，其設計、組裝，操作及保養之相關人員，須有充分之相關知識及經驗，及按照正常之操作程序使用，以維持安全運作及良好之效果。

It is hazardous in error assemble and operation of compressed air and its accessories; so, while selecting the product, the related personnel of design, assemble, operating and service should possess sufficient knowledge and experience, and follow normal operating procedure, in order to maintain safe operation and good effect.

- 安全須知是依據 ISO 4414: Pneumatic fluid power. 及 JSI B 8370 空氣系統通則規範制定的。

The safety notice is made according to ISO 4414; pneumatic fluid power and JSI B 8370 general requirement of air system.

※ 此安全須知，如有變更，恕不另行通知。
 ※ There will not be any notification if any change of this safety notice.

安全須知 / 注意事項 ② Safety notice / Common caution



本公司產品為適用於一般工業設備之使用；於設計、組裝使用及保養須遵守下列注意事項：

This product suitable for application in general industrial equipment; adhere to the following caution while designing, assembling, using and maintenance.



危險 Danger

1. 請勿使用於下列用途：

Please never use in the following application

- 用於操作、運送及管理上對人的生命及身體為目的之器具。
Use in operation, delivering and management of the appliance for the purpose of human life and body.
- 用於操作使用對人的生命及身體有明顯 " 危險 " 及安全顧慮之器具。
Use in operation which rise obvious "danger" and safety concern to human life and body.
- 特別以安全為目的，對人的生命及身體有安全影響之場合。
Special for safety purpose, situation with impact of safety to human life and body
- 2. 安全之確認，須避免下列情形造成對人體安全影響及設備之損壞。
Confirmation of safety shall avoid the following conditions which cause safety impact to human and damage of equipment.
- 機器，裝置物之操作，應注意在迴轉半徑及運作範圍時，應防止驅動物體之落下，或暴走而造成之人體受傷及設備損壞。
Operation of machine, device should note to the drop of driven object or race at the rotation radius and operation range cause injury of human and damage of equipment.
- 機器，裝置物之操作，應注意因供氣源及電源供應不良及瞬間中斷，造成之人體受傷及設備損壞。
Operation of machine, device should note the air supply source and poor power supply and interruption and cause injury of human and damage of equipment.
- 機器，裝置物之再啟動時，造成放置物品之飛出，造成之人體受傷及設備損壞。
When restarting the machine, device, may cause object flying out and cause injury of human and damage of equipment.



警告 Warning

1. 請勿於下列之環境及場合使用 Please never use in following situation：

- 在戶外及灰塵量大之環境。In outdoor dusty condition.
- 在有化學藥品，易燃品，腐蝕性及海水，高溫之環境；對產品之質量安定性有影響之場合。
To avoid chemical, corrosive and inflammable gas; to avoid sea water, high temperature place in surrounding.
- 在超出產品規格規範中之條件場合。
Exceed the condition in the specification of the product.
- 在容易受劇烈震動衝擊，對產品之質量有安定性之影響及破壞之場合。
In the place tend to receive rigorous shock impact, which affect the quality and stability of the product.
- 2. 請勿對產品之結構，功能作分解及改造。
Please don't make any modification or disassemble to the structure, function of the product.
- 3. 產品之保養，拆卸須注意電源及氣源等是否已關閉，避免造成危險及產品損壞。
Shut off the power switch and air source properly before service and maintenance, to avoid consequent hazard and damage of product.
- 4. 避免組裝及操作時，造成危險及產品損壞。
To avoid consequent hazard and damage of product while assembling and operation.



注意 Caution

- 1. 配管前要注意管線之乾淨，避免灰塵、髒物及止洩帶等吸入管線，影響產品操作功能。
Pay attention to the cleanliness of the pipeline while piping, to avoid dust, dirt and leak proof tape been sucked into the pipe line and affect the operation performance of the product.
- 2. 各類別產品，有分項說明安全注意事項，未明確部份，請洽詢本公司業務部門人員。
There are itemized cautions for various products, please contact our sales representative if you have any question.



二口二位氣控型電磁閥使用注意事項：

PRECAUTION FOR 2 PORT 2WAY AIR OPERATED VALVE USE:

1. 外部氣控型電磁閥，組裝方向錯誤時將導致誤動作與洩漏。
Air operated valve assembly and installation of the wrong direction, will produce misoperation, leakage situation.
2. 使用混入異物（玻璃粉等高硬度等異物）的流體時，會導致閥及其密封件之損壞。
When mix with other fluids, valve and seals will be damaged.
3. 電源接線時請勿接錯電線，配線完成後請再次確認是否正確接線。
When connecting the power wiring don't connect the wrong wire, please check again whether the wiring is correct after the wiring is completed
4. 高溫流體使用時，所使用的接頭、配管線等請使用耐熱性的產品。（嵌入式管接頭，氟素樹脂管，銅管等）
When using the high temperature fluid, please use heat-resistant products for the connectors and piping. (Insert fittings, Metal fittings, Fluoropolymer tubing)
5. 線圈鎖緊時勿施加過大外力，配管連接部的外側請用扳手支撐。
Do not apply excessive locking force in coil wiring, outside the piping connection use the wrench support.
6. 請避免使用於有振動源的場所，從本體到支撐點請盡量縮短，以免引起共振。
Avoid sources of vibration in the workplace, please try to shorten from the body to the anchor, avoid causing resonance
7. 垂直安裝時，如流體內有異物混入時，本體座內部會有異物等的殘留，請儘量避免。
When mounted vertically, such as fluid mixed with foreign body, inside there will be foreign body residue, please try to avoid it.

SPEC INDEX 規格索引

流體 Fluid	作動方式 Valve construction	規格 Specification	備註 Remarks	連接口徑 Connection port								接管口徑 Port size				頁碼 Page	
				6	8	10	15	20	25	32	40	50	C4	C6	C8		C10
				1/8	1/4	3/8	1/2	3/4	1	1 1/4	1 1/2	2	Ø4	Ø6	Ø8		Ø10
空氣 Air	直動式 Direct operated	SBS	不銹鋼本體 Stainless steel body	●										●			P8
		SU	PPS 本體 PPS body										●	●			P9
		SFW	PPS 本體 PPS body										●	●	●	●	P14
		SUD2	鍛造銅本體 Forge brass	●	●	●											P16
		SUS	不銹鋼本體 Stainless steel body				●	●	●	●	●	●					P18
		SAS	不銹鋼本體 Stainless steel body	●	●	●											P19
	直動 膜片式 Direct diaphragm type	SUW2	鍛造銅本體 Forge brass			●	●	●	●	●	●	●					P15
		SAS	不銹鋼本體 Stainless steel body				●	●	●	●	●	●					P19
		SDC	耐酸鹼 /PVC 本體 / Plastic steel body		●	●	●										P21
		SDC-TF	耐酸鹼 / 鐵弗龍本體 / Teflon body		●	●	●	●									P22
	外部 氣控式	SUB	鍛造銅本體 Forge brass		●	●											P23
		SUG	鑄造銅本體 Forge brass		●	●	●	●	●	●	●	●					P23
流體 Fluid	作動方式 Valve construction	規格 Specification	備註 Remarks	連接口徑 Connection port								接管口徑 Port size				頁碼 Page	
				6	8	10	15	20	25	32	40	50	C4	C6	C8		C10
				1/8	1/4	3/8	1/2	3/4	1	1 1/4	1 1/2	2	Ø4	Ø6	Ø8		Ø10
水 (常溫) Water	直動式 Direct operated	SU	PPS 本體 PPS body										●	●			P9
		SFW	PPS 本體 PPS body										●	●	●	●	P14
		SUD2	鍛造銅本體 Forge brass	●	●	●											P16
		SUS	不銹鋼本體 Stainless steel body				●	●	●	●	●	●					P18
		SAS	不銹鋼本體 Stainless steel body	●	●	●											P19
	直動 膜片式 Direct diaphragm type	SUG	鍛造銅本體 Forge brass		●	●	●	●	●	●	●	●					P29
		SUW2	鍛造銅本體 Forge brass			●	●	●	●	●	●	●					P15
		SAS	不銹鋼本體 Stainless steel body				●	●	●	●	●	●					P19
		SDC	耐酸鹼 /PVC 本體 / Plastic steel body		●	●	●										P21
		SDC-TF	耐酸鹼 / 鐵弗龍本體 / Teflon body		●	●	●	●									P22
流體 Fluid	作動方式 Valve construction	規格 Specification	備註 Remarks	連接口徑 Connection port								接管口徑 Port size				頁碼 Page	
				6	8	10	15	20	25	32	40	50	C4	C6	C8		C10
				1/8	1/4	3/8	1/2	3/4	1	1 1/4	1 1/2	2	Ø4	Ø6	Ø8		Ø10
真空 Vacuum	直動式 Direct operated	SU	PPS 本體 PPS body										●	●			P9
		SFW	PPS 本體 PPS body										●	●	●	●	P14
		SUD2	鍛造銅本體 Forge brass		●	●											P16
流體 Fluid	作動方式 Valve construction	規格 Specification	備註 Remarks	連接口徑 Connection port								接管口徑 Port size				頁碼 Page	
				6	8	10	15	20	25	32	40	50	C4	C6	C8		C10
				1/8	1/4	3/8	1/2	3/4	1	1 1/4	1 1/2	2	Ø4	Ø6	Ø8		Ø10
油 (循環油) Oil	直動式 Direct operated	SUD2	鍛造銅本體 Forge brass	●	●	●											P16
		SUS	不銹鋼本體 Stainless steel body					●	●	●	●	●	●	●	●		P18
		SUW2	不銹鋼本體 Stainless steel body				●	●	●	●	●	●	●	●	●		P17
		SUG	不銹鋼本體 Stainless steel body		●	●	●	●	●	●	●	●	●	●	●		P17
流體 Fluid	作動方式 Valve construction	規格 Specification	備註 Remarks	連接口徑 Connection port								接管口徑 Port size				頁碼 Page	
				6	8	10	15	20	25	32	40	50	C4	C6	C8		C10
				1/8	1/4	3/8	1/2	3/4	1	1 1/4	1 1/2	2	Ø4	Ø6	Ø8		Ø10
蒸氣 Steam	直動式 Direct operated	SUD2	鍛造銅本體 Forge brass	●	●	●											P16
		SUS	不銹鋼本體 Stainless steel body					●	●	●	●	●	●	●	●		P18
		SAS	不銹鋼本體 Stainless steel body	●	●	●											P19

SPEC INDEX 控制類組件 — 二口二位電磁閥系列

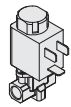

SBS 系列 直動式 (一般式) **P.8**
SBS SERIES Direct operated (General)

適用於空氣、水及蒸氣。〔不鏽鋼本體〕
Suitable for the fluid of air, water and vacuum. [Stainless steel body]

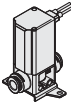

SU 系列 小型直動式二口電磁閥 **P.9**
Su SERIES Small size direct operated solenoid valve

適用於空氣、水及真空。〔PPS 塑膠本體〕
Suitable for the fluid of air, water and vacuum. [PPS body]



SFW 系列 小型直動式二口電磁閥 **P.14**
SFW SERIES Small size direct operated solenoid valve

適用於空氣、水及真空。〔PPS 塑膠本體〕
Suitable for the fluid of air, water and vacuum. [PPS body]



SUD2 系列 直動式 (一般式) **P.16**
SUD2 SERIES Direct operated (General)

適用於空氣、水、輕油及蒸氣。〔銅本體〕
Suitable for the fluid of air, water and vacuum. [Brass body]



SUW2 系列 直動膜片式 (大流量) **P.17**
SUW2 SERIES Direct diaphragm type (High flow)

適用於空氣、水及輕油等用途。〔銅本體〕
Suitable for the fluid of air, water and light oil. [Brass body]



SUS 系列 直動式 (高溫蒸氣用) **P.18**
SUS SERIES Direct operated (High temperature steam)

適用於空氣、水、蒸氣及輕油之場合。〔銅本體〕
Suitable for the place of steam, light oil, the high pressure water and air. [Brass body]



SAS 系列 直動式 (一般式) **P.19**
SAS SERIES Direct operated (General)

適用於空氣、水、蒸氣之場合。〔不銹鋼本體〕
Suitable for the place of steam, the water and air. [Stainless steel body]



SAS 系列 直動膜片式 (大流量) **P.20**
SAS SERIES Direct diaphragm type (High flow)

適用於水及空氣之場合。〔不鏽鋼本體〕
Suitable for the place of water and air. [Stainless steel body]



SDC 系列 直動膜片式 (耐強酸用) **P.21**
SDS SERIES Direct diaphragm type (Able to bear the strong acid to use)

適用於酸鹼性及腐蝕性之流體。〔PVC 塑鋼本體〕
Suitable for the fluid of acid, alkali and corrosive. [Plastic steel body]



SDC 系列 直動膜片式 (鐵氟龍閥體耐強酸用) **P.22**
SDS SERIES Direct diaphragm type (Teflon niuemon can able to bear the strong acid to use)

適用於酸鹼性及腐蝕性之流體。〔鐵氟龍本體〕
Suitable for the fluid of acid, alkali and corrosive. [Teflon body]



SUB 系列 二口氣控閥 (氣控型、線圈型) **P.23**
SUB SERIES Two port and two way cylinder valve (Air pilot type 、 Coil type)

適用於空氣。〔銅本體〕
Suitable for the fluid of air, alkali and corrosive. [Teflon body]



SUG 系列 二口氣控閥 **P.29**
SUG SERIES Two port and two way cylinder valve

適用於空氣、水及油。〔銅本體〕
Suitable for the fluid of air, water and light oil. [Brass body]

SBS 系列 電磁閥 - 直動式 (一般式)

SBS series - Two port and two way direct operated valve (General)

規格表與訂購說明 Specification and How to Order

▶ 訂購稱呼代號 How to Order

SBS	01	24 VDC	K	L
二口二位置電磁閥 SBS : 直動式 (一般式) 2 positions solenoid valve SBS : Direct operated (General)	尺寸規格 01 : 1/8" C6 : 接頭型 C6 (詳見規格表) Dimensions: 01 : 1/8" C6 : Fitting type C6 (Please refer to specification)	電壓 / Voltage : 24 VDC / 6.5W 110 VAC / 8.5VA 220 VAC / 8.5VA	線圈接線型式 : K : 附 DIN 接線盒 不附燈 W : 附電線長度 500mm Connection type : K : With DIN terminal without indicate light W : With wire length 500mm	線圈接線型式 : 無記號 : 標準型 L : 附指示燈 Connection type None : Standard type L : With LED

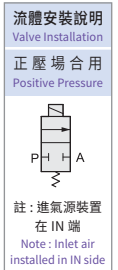

▶ 規格表 Specification

項目 Item	機種 Model	SBS-01	SBS-C6
使用流體 Fluid		適用於空氣、水及蒸氣 Suitable for the place of steam, the water and air.	
使用溫度範圍 Range of service temperature	°C	-5 °C ~ 80 °C	
閥位置數 Number of position ports		二口二位置電磁閥 2 ports 2 positions solenoid valve	
閥仕様 Valve function		常閉型 Normally close	
切控方法 (使用仕様) Operating method		直動式 (一般式) Direct operated (General)	
連接口徑 Connection port		1/8"	Ø6
有效斷面積 CV 值 CV value	mm ²	4.9	4.9
使用壓力範圍 (最大範圍) Range of operating pressure (Max. range) kgf/cm ² (KPa)	空氣 AIR 水 (常溫) Water 蒸氣 Steam	0~7 (0~70)	
材質 Material	本體 Body	精密鑄造不銹鋼 Cast the stainless steel accurately	
	膜片 Diaphragm	NBR	
	彈簧 Spring	不銹鋼 Stainless steel	
重量 Weight	kg	0.11	0.11

註：本製品不適用於高溫液態，冷卻時
為固態之流體，腐蝕性之流體及粘
度超過 20CST 之流體。

Note: This product is not suitable for
the liquid of high temperature,
the fluid of solid while cooling
and the fluid of corrosive and
viscosity exceed 20CST

▶ 外觀圖形尺寸 External Dimensions

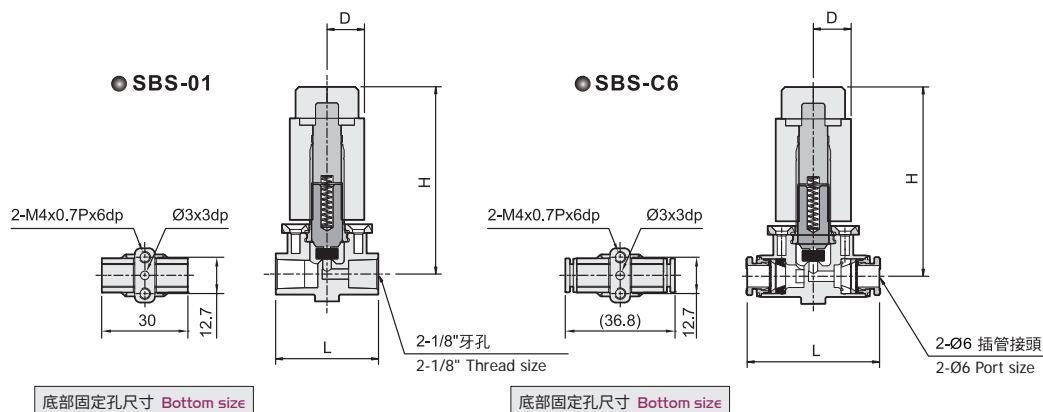

尺寸 Code / 機種 Model	SBS-01	SBS-C6
D	11	11
H	54.6	54.6
L	30	32.6

SU 系列 小型直動式二口電磁閥

SU series - Small size direct operated solenoid valve

規格表與訂購說明 Specification and How to Order

內部結構圖 Internal Structure

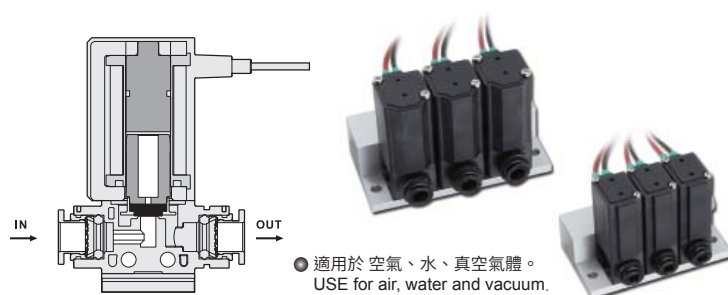

流體安裝說明
Valve Installation
正壓場合用
Positive Pressure



註：進氣源裝置
在 IN 端
Note: Inlet air
installed in IN side

流體安裝說明
Valve Installation
負壓場合用
Negative Pressure

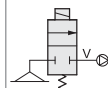

註：真空源裝置
在 OUT 端
Note: Vacuum
installed in OUT side

規格表 Specification

項目 Item	機種 Model	SU12	SU22
使用流體 Fluid		適用於空氣、水和真空 Suitable for the fluid of air, water and vacuum.	
使用溫度範圍 Ambient and fluid temperature °C		5 °C ~ 60 °C	
閥位置數 Number of position ports		二口二位電磁閥 2 ports 2 positions solenoid valve	
閥仕様 Valve function		常閉型 NC (Normal close)	
切控方法 (使用仕様) Operating method		直動式 (一般式) Direct operated (General)	
使用壓力範圍 Range of operating pressure	kgf/cm ² (KPa)	0 ~ 9.0 (0 ~ 900)	
最大耐壓力 Withstand pressure	kgf/cm ² (KPa)	10 (1000)	
連接口徑 Connection port		Ø4	Ø6
節流孔徑 Orifice diameter	mm Ø	1.6	3.3
有效斷面積 CV 值 CV value	mm ²	1.26 (0.07)	5.4 (0.3)
最大作動壓力差 (註1) The maximum difference between inlet and outlet pressure	kgf/cm ² (KPa)	4	2
使用壓力範圍 (最大範圍) Range of operating pressure (Max. range) kgf/cm ² (KPa)	空氣 AIR	0 ~ 9 (0 ~ 900)	
	水 (常溫) Water		
	真空 Vacuum	-1 ~ 0 (-100 ~ 0)	
材質 Material	本體 Body	PPS	
	線圈 Coil	PBT-G30	
重量 Weight	kg	0.05	0.08

註 1：最高作動壓力差為：進氣端壓力大於出氣端壓力值差。

Note1: The maximum operating pressure differential: The pressure of inlet is larger than outlet pressure.

訂購稱呼代號 How to Order

SU	12	C4	DC24	W	C1	聯座及數量 Station number
機種式樣 Model	機種代號 Code Number	接頭型式 Port Size	電壓型式 Voltage type	出線型式 Wire type	支架固定型 Bracket type	
SU 系列 二口二位電磁閥 SU series : Small size direct operated solenoid valve	12 12 系列 Series 22 22 系列 Series	記號 Code 管徑 Thread 機種規格 Model	記號 Code 機種規格 Model	直接出線 Lead wire type (附線長 300mm) (Wire length 300mm)	本體固定型 Body mount type	無記號：不附聯座 NONE: Not include base M 2 = 2 聯組 station M 3 = 3 聯組 station : = : M10 = 10 聯組 station ※ 聯座型不附支架 ※ Multi station type not include bracket
		C4 C4 SU12 C6 C6 SU22 ※ 進出氣孔型式	SU12 DC24 V / 2.5W SU22 DC24 V / 3W			

SU12 系列 小型直動式二口電磁閥

SU series - Small size direct operated solenoid valve

外觀圖形尺寸 / 單體型式 / 附加固定架 External Dimensions / Single unit / With bracket

► SU12-W-C1

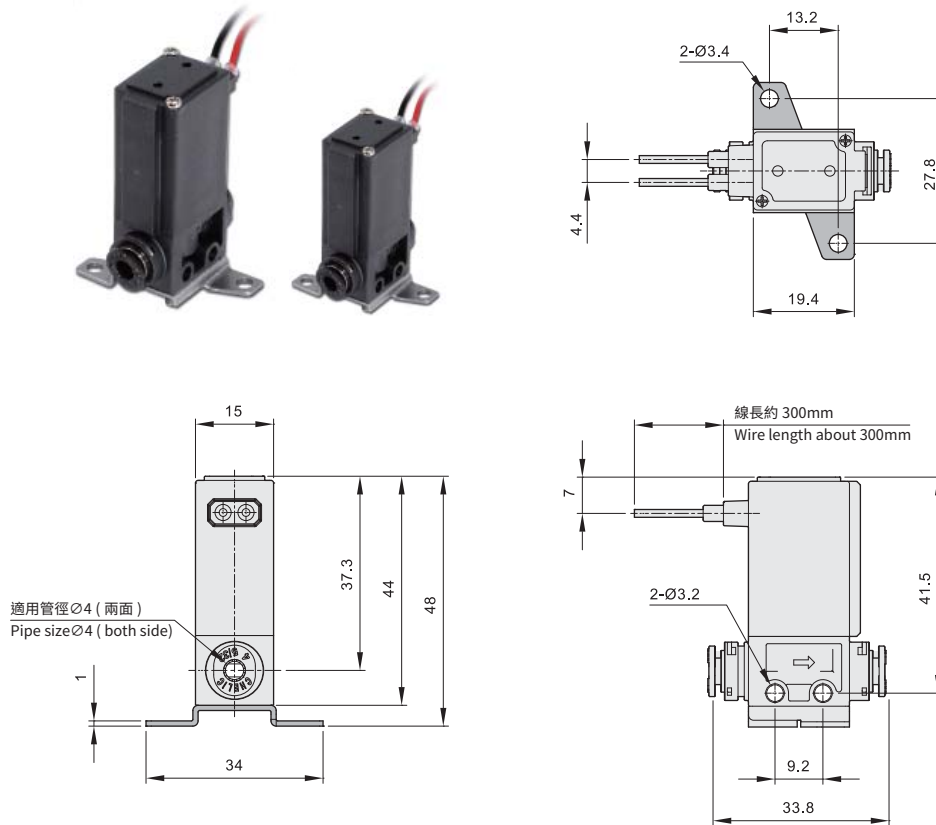

► SU12-W-C2

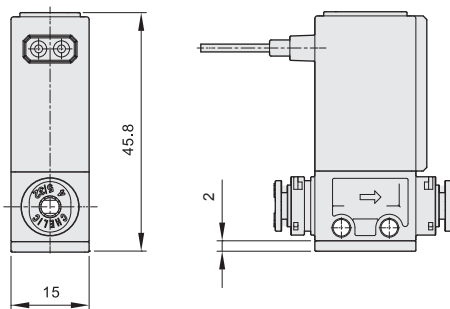

► 真空場合之安裝型式說明：

For vacuum use

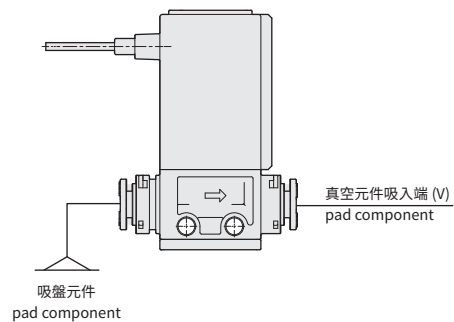

※ 註：本體上之箭頭指示為正壓接法，反之；負壓反接。

SU12 系列 小型直動式二口電磁閥

SU series - Small size direct operated solenoid valve

外觀圖形尺寸 / 聯座尺寸 External Dimensions / Multi station type

► SU12 聯座尺寸



聯座型式不適用真空場合
Multi station type can't use in vacuum.

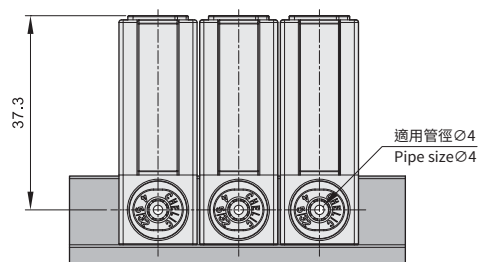
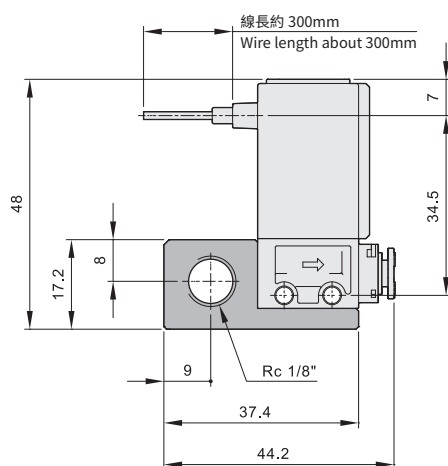
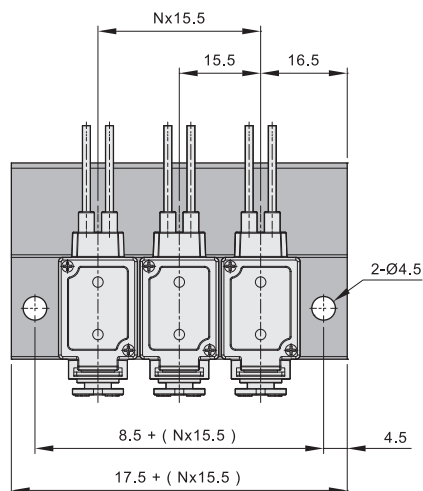

SBS
電磁閥

SU
電磁閥

SFW
電磁閥

SUD2
電磁閥

SUW2
電磁閥

SUS
電磁閥

SAS
電磁閥

SDC
電磁閥

SUB
氣控閥

SUG
氣控閥

SU22 系列 小型直動式二口電磁閥

SU22 series - Small size direct operated solenoid valve

外觀圖形尺寸 / 單體型式 / 附加固定架 External Dimensions / Single unit / with bracket

► SU22-W-C1

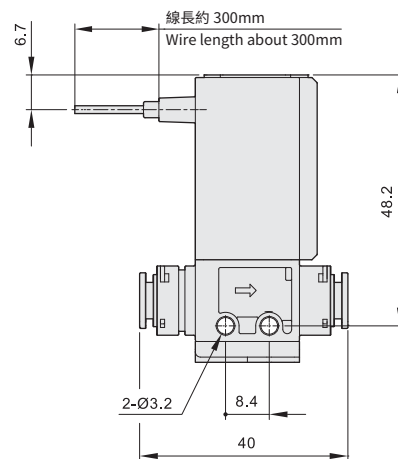
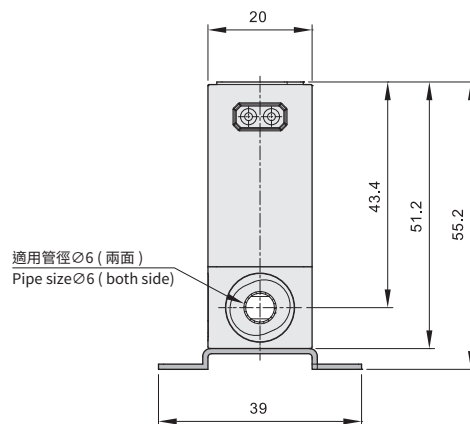
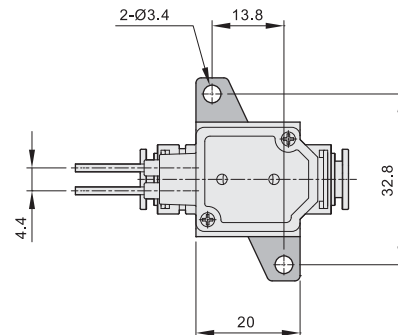

► SU22-W-C2

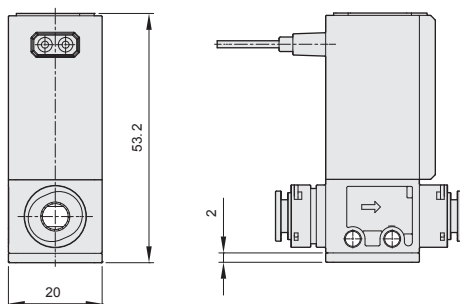

► 真空場合之安裝型式說明：

For vacuum use

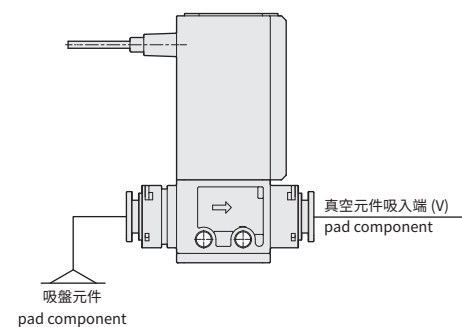

※ 註：本體上之箭頭指示為正壓接法，反之；負壓反接。

SU22 系列 - 小型直動式二口電磁閥

外觀圖形尺寸 / 聯座尺寸 External Dimensions / Multi station type

SU22 聯座尺寸

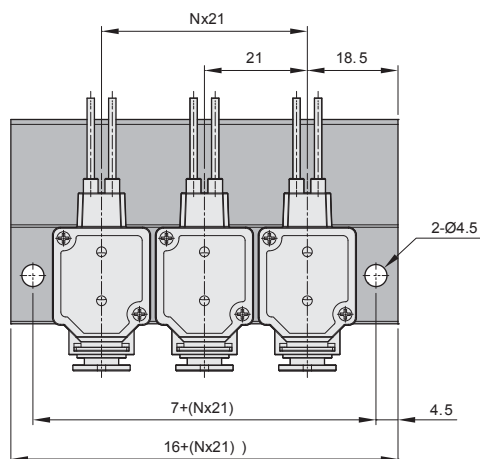

聯座型式不適用真空場合
Multi station type can't use in vacuum.

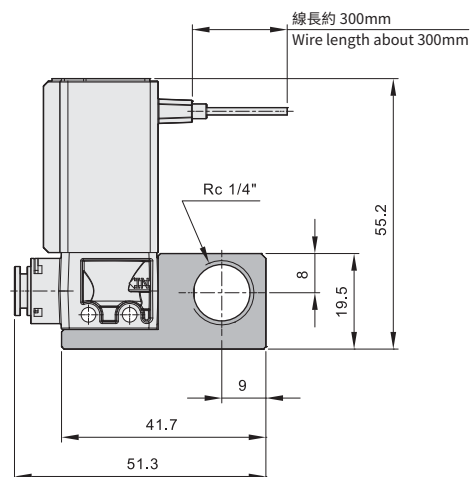
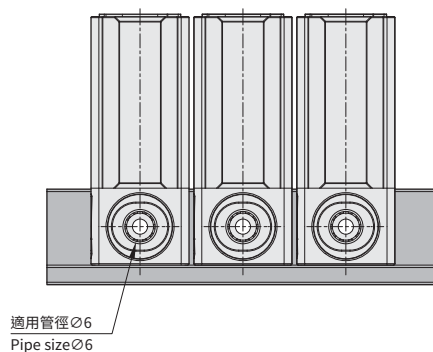

SBS
電磁閥

SU
電磁閥

SFW
電磁閥

SUD2
電磁閥

SUW2
電磁閥

SUS
電磁閥

SAS
電磁閥

SDC
電磁閥

SUB
氣控閥

SUG
氣控閥

SFW 系列 - 小型直動式二口電磁閥

SFW series - Direct Operated 2 Port Solenoid Valve

規格表與訂購說明 Specification and How to Order

內部結構圖 Internal Structure

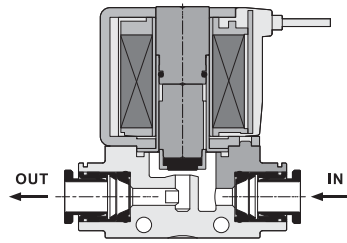

● 適用於空氣、水、真空氣體。
USE for air, water and vacuum.

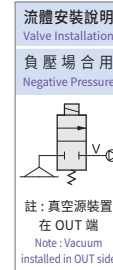
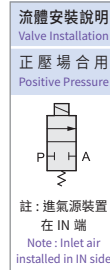

規格表 Specification

項目 Item	機種 Model	SFW30	SFW40
使用流體 Fluid		適用於空氣、水及真空氣體 USE for air, water and vacuum	
使用溫度範圍 Ambient and fluid temperature °C		0 °C ~ 50 °C	
閥位置數 Number of position ports		二口二位電磁閥 2 ports 2 positions solenoid valve	
閥仕樣 Valve function		常閉型 Normally close	
切控方法 (使用仕樣) Operating method		直動式 Direct operated	
最大耐壓力 kgf/cm ² (KPa)		10 (1000)	
連接口徑 Connection port		Ø 4, Ø 6	Ø 8, Ø 10
有效斷面積 CV 值 CV value		5.4 (0.3)	19.8 (1.1)
最高作動壓力差 (註 1) kgf/cm ² (KPa)		1	0.2
使用壓力範圍 (最大範圍) Range of operating pressure (Max. range) kgf/cm ² (KPa)	空氣 AIR	0~9 (0~900)	
	水 (常溫) Water		
	真空 Vacuum	-1~0 (-100 ~ 0)	
手壓按鈕 Push button		無 None	

註 1：最高作動壓力差為：進氣端壓力大於出氣端壓力值差。

Note1: The maximum operating pressure differential: The pressure of inlet is larger than outlet pressure.

訂購稱呼代號 How to Order

SFW	30	C4	DC24	W
機種式樣 Model	機種代號 Code Number	接頭型式 Port Size	電壓型式 Voltage type	出線型式 Wire type
SFW 系列 電磁閥 SFW series: Solenoid valve	30 30 系列 Series 40 40 系列 Series	記號 Code 管徑 Thread 機種規格 Model	記號 Code 瓦數 Thread 機種規格 Model	標準出線 Standard
		C4 Ø4 SFW30 C6 Ø6 SFW30 C8 Ø8 SFW40 C10 Ø10 SFW40	DC12 3.3W SFW30 7.5W SFW40 DC24 3.1W SFW30 8.1W SFW40	(附線長 300mm) (Wire length 300mm)

SFW 系列 - 小型直動式二口電磁閥

SFW series - Direct Operated 2 Port Solenoid Valve

外觀圖形尺寸 / 單體型式 External Dimensions / Single unit

► SFW - 30

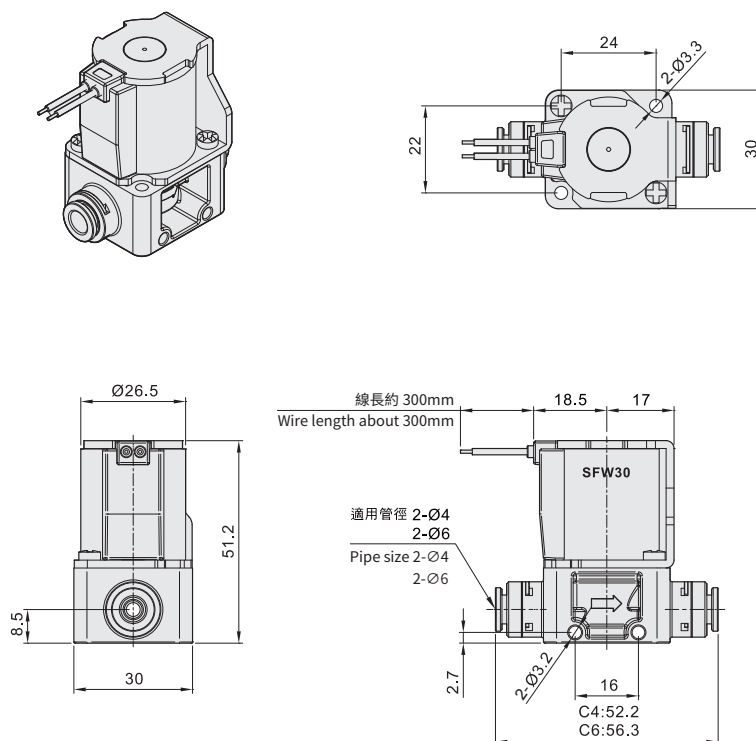

► SFW - 40

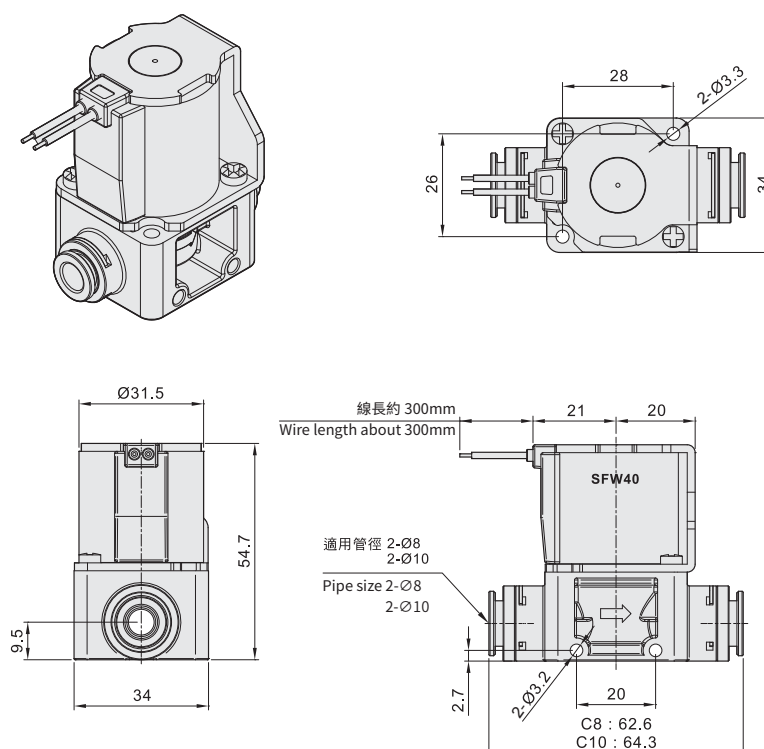

SBS
電磁閥

SU
電磁閥

SFW
電磁閥

SUD2
電磁閥

SUW2
電磁閥

SUS
電磁閥

SAS
電磁閥

SDC
電磁閥

SUB
氣控閥

SUG
氣控閥

SUD2 系列 電磁閥 - 直動式 (一般式)

SUD2 series - Solenoid valve Direct operated (General)

規格表與訂購說明 Specification and How to Order

訂購稱呼代號 How to Order

SUD2	10	110VAC	K
二位電磁閥 SUD2: 直動式 (一般式) 2 positions solenoid valve SUD2: Direct operated (General)	尺寸規格 (詳見規格表) Dimensions: (Please refer to specification)	電壓 / Voltage: 110 VAC 220 VAC DC 24 V	無記號: 標準型 K: 線圈接線盒型式 None: Standard K: DIN terminal type

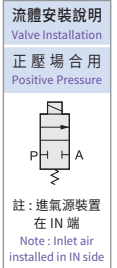

規格表 Specification

項目 Item		機種 Model	SUD2-6	SUD2-6-K	SUD2-8	SUD2-8-K	SUD2-10	SUD2-10-K
使用流體 Fluid			適用於空氣、水、輕油及蒸氣 Suitable for the place of steam, light oil, the high pressure water and air					
使用溫度範圍 Ambient and fluid temperature °C			-5° C ～ 80° C					
閥位置數 Number of position ports			二口二位電磁閥 2 ports 2 positions solenoid valve					
閥仕様 Valve function			常閉型 (常開型為訂製品) Normally close (Custom made for normally open type)					
切控方法 (使用仕様) Operating method			直動式 (一般式) Direct operated (General)					
連接口徑 Connection port		Rc	1/8	1/4		3/8		
節流孔徑 Orifice diameter			2.5				4	
有效斷面積 CV 值 CV value			0.23				0.6	
使用壓力範圍 (最大範圍) Range of operating pressure (Max. range) kgf/cm ² (KPa)	空氣 AIR	0~7 (0~700)				0~10 (0~1000)		
	水 (常溫) Water							
	油 (循環油) Oil							
	蒸氣 Steam							
材質 Material	本體 Body	鍛造銅製品 Forge brass						
	膜片 Diaphragm	NBR , Viton , Silicon						
	彈簧 Spring	不鏽鋼 Stainless steel						
重量 Weight kg			0.3				0.6	0.5

註: 本製品不適用於高溫液態, 冷卻時
為固態之流體, 腐蝕性之流體及粘
度超過 20CST 之流體。

Note: This product is not suitable for
the liquid of high temperature,
the fluid of solid while cooling
and the fluid of corrosive and
viscosity exceed 20CST

外觀圖形尺寸 External Dimensions

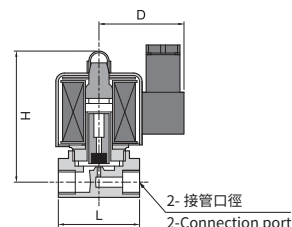
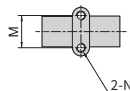
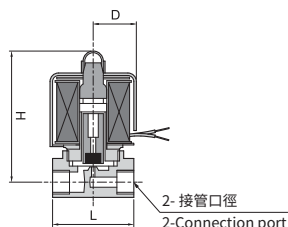

標準型 Standard type

底部尺寸 Bottom size

K 型 K: DIN terminal type

尺寸 Code / 機種 Model	SUD2-6	SUD2-6-K	SUD2-8	SUD2-8-K	SUD2-10	SUD2-10-K
D	21	56	21	56	48	58
H	66	66	65		75	
L	41	41	42		53	
M	19	18	18		21	
N	M4 x 0.7P	M4 x 0.7P	M5 x 0.8P		M5 x 0.8P	

SUW2 系列 電磁閥 - 直動膜片式 (大流量)

SUD2 series - Solenoid valve Direct diaphragm type (High flow)

規格表與訂購說明 Specification and How to Order

訂購稱呼代號 How to Order

SUW2	—	20	—	110VAC	—	K
二位電磁閥 SUW2:直動膜片式(大流量) 2 positions solenoid valve SUW2 : Direct diaphragm type (High flow)		尺寸規格 (詳見規格表) Dimensions : (Please refer to specification)		電壓 / Voltage : 110 VAC 220 VAC DC 24 V		無記號:標準型 K:線圈接線盒型式 None : Standard K : DIN terminal type



流體安裝說明
Valve Installation

正壓場合用
Positive Pressure



註:進氣源裝置
在 IN 端
Note: Inlet air
installed in IN side

規格表 Specification

項目 Item	機種 Model	SUW2-10/-K	SUW2-15/-K	SUW2-20/-K	SUW2-25/-K	SUW2-35/-K	SUW2-40/-K	SUW2-50/-K
使用流體 Fluid	適用於空氣、水及輕油之流體 Suitable for the fluid of air, water and light oil.							
使用溫度範圍 Ambient and fluid temperature °C	-5° C ~ 80° C							
閥位置數 Number of position ports	二口二位電磁閥 2 ports 2 positions solenoid valve							
閥仕樣 Valve function	常閉型 (常開型為訂製品) Normally close (Custom made for normally open type)							
切控方法 (使用仕樣) Operating method	直動式 (大流量) Direct diaphragm type (High flow)							
連接口徑 Connection port		RC 3/8	RC 1/2	RC 3/4	RC 1	G 1 1/4	G 1 1/2	G 2
節流孔徑 Orifice diameter		10	15	20	25	35	40	50
有效斷面積 CV 值 CV value		2.4	4.5	8.6	12	24	28	48
使用壓力範圍 (最大範圍) Range of operating pressure (Max. range) kgf/cm ² (KPa)	空氣 AIR	0~7 (0~700)						
	水 (常溫) Water	0~5 (0~500)						
	油 (循環油) Oil							
材質 Material	本體 Body	鍛造銅製品 Forge brass						
	膜片 Diaphragm	NBR, Viton, Silicon						
	彈簧 Spring	不銹鋼 Stainless steel						
重量 Weight kg		0.9	1.0/0.9	1.8/1.2	3.2/2.7	3.5/2.7	5.4/4.4	

註: 本製品不適用於高溫液態, 冷卻時為固態之流體, 腐蝕性之流體及粘度超過 20CST 之流體。

Note: This product is not suitable for the liquid of high temperature, the fluid of solid while cooling and the fluid of corrosive and viscosity exceed 20CST

外觀圖形尺寸 External Dimensions

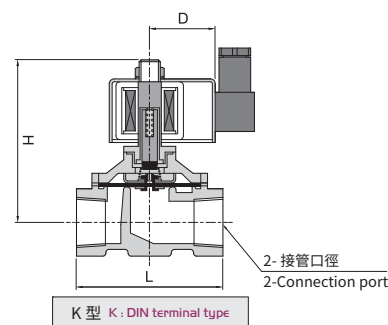
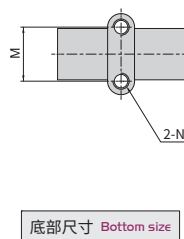
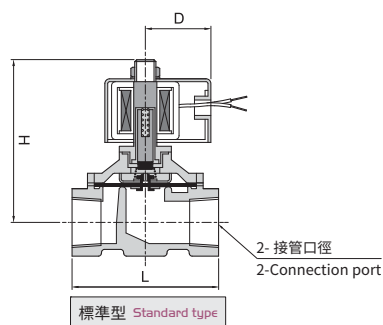

尺寸 Code / 機種 Model	SUW2-10/-K	SUW2-15/-K	SUW2-20/-K	SUW2-25/-K	SUW2-35/-K	SUW2-40/-K	SUW2-50/-K
D	48 / 58						
H	97	97	99	103	135		155
L	67	67	71	92	115		155
M	30	30	27	—	—		—
N	M6 x 1.0P	M6 x 1.0P	M6 x 1.0P	—	—		—

SBS
電磁閥

SU
電磁閥

SFW
電磁閥

SUD2
電磁閥

SUW2
電磁閥

SUS
電磁閥

SAS
電磁閥

SDC
電磁閥

SUB
氣控閥

SUG
氣控閥

SUS 系列 電磁閥 - 直動式 (高溫蒸氣用)

SUS series - Solenoid valve direct operated (High temperature steam)

規格表與訂購說明 Specification and How to Order

訂購稱呼代號 How to Order

SUS	—	20	—	110VAC
<div> <div>二位置電磁閥 SUS: 直動式 (高溫蒸氣用) 2 ports 2 positions solenoid valve SUS: Direct operated (The high-temperature and steam use)</div> <div>尺寸規格 (詳見規格表) Dimensions : (Please refer to specification)</div> <div>電壓 / Voltage : 110 VAC 220 VAC DC 24 V</div> </div>				

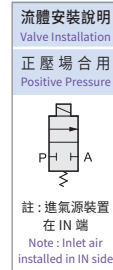

規格表 Specification

項目 Item		機種 Model	SUS-15	SUS-20	SUS-25	SUS-35	SUS-40	SUS-50
使用流體 Fluid			適用於蒸氣、輕油、水及空氣之場合 Suitable for the place of steam, light oil, the steam and air					
使用溫度範圍 Ambient and fluid temperature °C			-5 °C ~ 185 °C					
閥位置數 Number of position ports			二口二位電磁閥 2 ports 2 positions solenoid valve					
閥仕樣 Valve function			常閉型 (常開型為訂製品) Normally close (Custom made for normally open type)					
切控方法 (使用仕樣) Operating method			直動式 (高溫蒸氣用) Direct operated (High temperature steam)					
連接口徑 Connection port Rc			1/2	3/4	1	1 1/4	1 1/2	2
節流孔徑 Orifice diameter mm Ø			17		22	30	32	50
有效斷面積 CV 值 CV value mm²			4.0	6.0	12	18	22	48
使用壓力範圍 (最大範圍) Rang of operating pressure (Max. range) kgf/cm² (KPa)	空氣 AIR		0.5~15 (5~150)					
	水 (常溫) Water		0.5 ~ 15 (5 ~ 150)			1.0~10 (10~100)		
	油 (循環油) Oil		0.5 ~ 10 (5 ~ 100)			1.0~10 (10~100)		
	蒸氣 Steam		0.5 ~ 10 (5 ~ 100)					
材質 Material	本體 Body		鍛造銅製品 Forge brass					
	活塞 Piston		銅 Brass					
	電磁管、頂針 Armature/Thimble		不銹鋼 Stainless steel					
	彈簧 Spring		不銹鋼 Stainless steel					
重量 Weight kg			1.7		2.0	3.1	3.3	7.2

註：本製品不適用於高溫液態，冷卻時為固態之流體，腐蝕性之流體及粘度超過 20CST 之流體。

Note: This product is not suitable for the liquid of high temperature, the fluid of solid while cooling and the fluid of corrosive and viscosity exceed 20CST

外觀圖形尺寸 External Dimensions

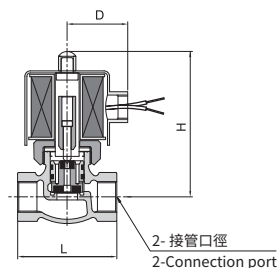

尺寸 Code / 機種 Model	SUS-15	SUS-20	SUS-25	SUS-35	SUS-40	SUS-50
D	58					
H	125	125	133	141		175
L	82		91	110		163

SAS 系列 電磁閥 - 直動式 (一般式)

SAS series - Solenoid valve Direct operated (General)

規格表與訂購說明〔不銹鋼本體〕 Specification and How to Order [Stainless steel]

訂購稱呼代號 How to Order

SAS	—	6A	—	110VAC
<div> <div>二位電磁閥 SAS: 直動式 (一般式) 2 ports 2 positions solenoid valve SAS :Direct operated (General)</div> <div>尺寸規格 (詳見規格表) Dimensions : (Please refer to specification)</div> <div>電壓 / Voltage : 110 VAC 220 VAC DC 24 V</div> </div>				

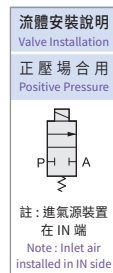

規格表 Specification

項目 Item		機種 Model	SAS-6A	SAS-8A	SAS-10A
使用流體 Fluid			適用於蒸氣、水及空氣之流體 Suitable for the place of steam, the water and air.		
使用溫度範圍 Ambient and fluid temperature °C			-5 °C ~ 185 °C		
閥位置數 Number of position ports			二口二位電磁閥 2 ports 2 positions solenoid valve		
閥仕樣 Valve function			常閉型 (常閉型為訂製品) Normally close (Custom made for normally open type)		
切控方法 (使用仕樣) Operating method			直動式 (一般式) Direct operated (General)		
連接口徑 Connection port		Rc	1/8	1/4	3/8
節流孔徑 Orifice diameter		mm Ø	2.5	2.5	4
有效斷面積 CV 值 CV value		mm ²	0.23	0.23	0.58
使用壓力範圍 (最大範圍) Rang of operating pressure (Max. range) kgf/cm ² (KPa)	空氣 AIR	0 ~ 7 (0 ~ 70)			0~10 (0~100)
	水 (常溫) Water				
	蒸氣 Steam				
材質 Material	本體 Body	精密鑄造不銹鋼 Cast the stainless steel accurately			
	膜片 Diaphragm	NBR , Viton , Silicon , PTFE			
	彈簧 Spring	不銹鋼 Stainless steel			
重量 Weight		kg	0.3	0.3	0.6

註：本製品不適用於高溫液態，冷卻時為固態之流體，腐蝕性之流體及粘度超過 20CST 之流體。

Note: This product is not suitable for the liquid of high temperature, the fluid of solid while cooling and the fluid of corrosive and viscosity exceed 20CST

外觀圖形尺寸 External Dimensions

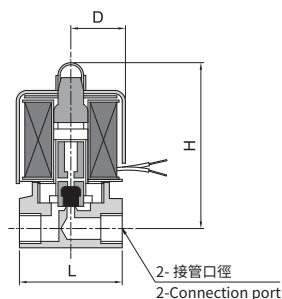

尺寸 Code / 機種 Model	SAS-6A	SAS-8A	SAS-10A
D	21	21	48
H	63	63	75
L	41	41	54

SBS
電磁閥

SU
電磁閥

SFW
電磁閥

SUD2
電磁閥

SUW2
電磁閥

SUS
電磁閥

SAS
電磁閥

SDC
電磁閥

SUB
氣控閥

SUG
氣控閥

SAS 系列 電磁閥 - 直動膜片式 (大流量)

SAS series - Solenoid valve direct diaphragm type (High flow)

規格表與訂購說明 [不銹鋼本體] Specification and How to Order [Stainless steel]

訂購稱呼代號 How to Order

SAS	15A	110VAC
二位二位置電磁閥 SAS : 直動膜片式 (大流量) 2 ports 2 positions solenoid valve SAS : Direct diaphragm type (Big flow rate)	尺寸規格 (詳見規格表) Dimensions : (Please refer to specification)	電壓 / Voltage : 110 VAC 220 VAC DC 24 V

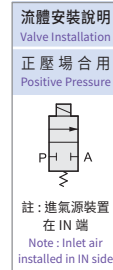

規格表 Specification

項目 Item	機種 Model	SAS-15A	SAS-20A	SAS-25A	SAS-35A	SAS-40A	SAS-50A
使用流體 Fluid		適用於水及空氣之場合 Suitable for the place of water and air					
使用溫度範圍 Ambient and fluid temperature	°C	-5 °C ~ 80 °C					
閥位置數 Number of position ports		二口二位電磁閥 2 ports 2 positions solenoid valve					
閥仕様 Valve function		常閉型 (常開型為訂製品) Normally close (Custom made for normally open type)					
切控方法 (使用仕様) Operating method		直動式 (大流量) Direct diaphragm type (High flow)					
連接口徑 Connection port	Rc	1/2	3/4	1	1 1/4	1 1/2	2
節流孔徑 Orifice diameter	mm Ø	15	20	25	35	40	50
有效斷面積 CV 值 CV value	mm ²	4.5	8.6	12	24	28	48
使用壓力範圍 (最大範圍) Range of operating pressure (Max. range) kgf/cm ² (KPa)	空氣 AIR	0~7 (0~70)					
	水 (常溫) Water	0~5 (0~50)					
材質 Material	本體 Body	精密鑄造不銹鋼 Cast the stainless steel accurately					
	膜片 Diaphragm	NBR , Viton , Silicon					
	電磁管、頂針 Armature/Thimble	不銹鋼 Stainless steel					
	彈簧 Spring	不銹鋼 Stainless steel					
重量 Weight	kg	0.9	1.0	1.6	3.2	3.4	5.8

註：本製品不適用於高溫液態，冷卻時為固態之流體，腐蝕性之流體及粘度超過 20CST 之流體。

Note: This product is not suitable for the liquid of high temperature, the fluid of solid while cooling and the fluid of corrosive and viscosity exceed 20CST

外觀圖形尺寸 External Dimensions

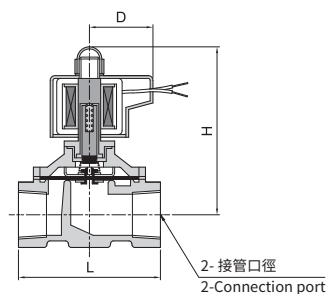

尺寸 Code / 機種 Model	SAS-15A	SAS-20A	SAS-25A	SAS-35A	SAS-40A	SAS-50A
D	50			58		
H	100	102	106	140		170
L	70	73	93	125		167

SDC 系列 電磁閥 - 直動膜片式 (耐強酸鹼用)

SDC series - Solenoid valve direct diaphragm type (Able to bear the strong acid to use)

規格表與訂購說明 Specification and How to Order

訂購稱呼代號 How to Order

SDC	8	110VAC
二口二位置電磁閥 SDC: 直動膜片式 (耐強酸鹼用)	尺寸規格 (詳見規格表) Dimensions: (Please refer to specification)	電壓 / Voltage: 110 VAC 220 VAC DC 24 V
2 ports 2 positions solenoid valve SDC: Direct diaphragm type		

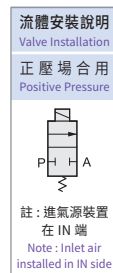

規格表 Specification

項目 Item	機種 Model	SDC-8	SDC-10	SDC-15
使用流體 Fluid		適用於酸鹼性及腐蝕性之流體 Suitable for the fluid of acid, alkali and corrodive		
使用溫度範圍 Ambient and fluid temperature	°C	-5 °C ~ 80 °C		
閥位置數 Number of position ports		二口二位置電磁閥 2 ports 2 positions solenoid valve		
閥仕様 Valve function		常閉型 (常開型為訂製品) Normally close (Custom made for normally open type)		
切控方法 (使用仕様) Operating method		直動膜片式 (耐強酸鹼用) Direct diaphragm type (Able to bear the strong acid)		
連接口徑 Connection port	Rc	1/4	3/8	1/2
節流孔徑 Orifice diameter	mm Ø	6.5		
有效斷面積 CV 值 CV value	mm ²	0.28		
使用壓力範圍 (最大範圍) Range of operating pressure (Max. range) kgf/cm ² (KPa)	空氣 AIR	0~1 (0~10)		
	水 (常溫) Water			
材質 Material	本體 Body	PVC		
	膜片 Diaphragm	PTFE		
	彈簧 Spring	不銹鋼 Stainless steel		
重量 Weight	kg	0.6		

註: 本製品不適用於高溫液態, 冷卻時
為固態之流體, 腐蝕性之流體及粘
度超過 20CST 之流體。

Note: This product is not suitable for
the liquid of high temperature,
the fluid of solid while cooling
and the fluid of corrosive and
viscosity exceed 20CST

外觀圖形尺寸 External Dimensions

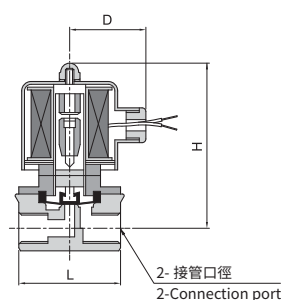

尺寸 Code / 機種 Model	SDC-8	SDC-10	SDC-15
D	48	48	48
H	90	90	93
L	54	54	54

SBS
電磁閥SU
電磁閥SFW
電磁閥SUD2
電磁閥SUW2
電磁閥SUS
電磁閥SAS
電磁閥SDC
電磁閥SUB
氣控閥SUG
氣控閥

SDC 系列 電磁閥 - 直動膜片式 (鐵氟龍閥體耐強酸鹼用)

SDC series - Solenoid valve - Direct diaphragm type (Teflon niuemon can bear the strong acid and alkai)

規格表與訂購說明 Specification and How to Order

訂購稱呼代號 How to Order

SDC	8-TF	110VAC
二位二位置電磁閥 SDC : 直動膜片式 (鐵氟龍閥體耐強酸鹼用)	尺寸規格 (詳見規格表) Dimensions : (Please refer to specification)	電壓 / Voltage : 110 VAC 220 VAC DC 24 V
2 ports 2 positions solenoid valve SDC : Direct diaphragm type		

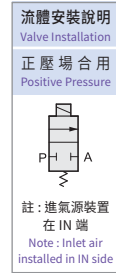

規格表 Specification

項目 Item	機種 Model	SDC-8-TF	SDC-10-TF	SDC-15-TF	SDC-20-TF
使用流體 Fluid		適用於酸鹼性及腐蝕性之流體 Suitable for the fluid of acid, alkali and corrodive			
使用溫度範圍 Ambient and fluid temperature	°C	-5 °C ~ 80 °C			
閥位置數 Number of position ports		二口二位電磁閥 2 ports 2 positions solenoid valve			
閥仕樣 Valve function		常閉型 (常開型為訂製品) Normally close (Custom made for normally open type)			
切控方法 (使用仕樣) Operating method		直動膜片式 (鐵氟龍閥體耐強酸鹼用) Direct diaphragm type (Teflon niuemon can able to bear the strong acid to use)			
連接口徑 Connection port	Rc	1/4	3/8	1/2	3/4
節流孔徑 Orifice diameter	mm Ø	6.5			13
有效斷面積 CV 值 CV value	mm ²	0.28			4
使用壓力範圍 (最大範圍) Rang of operating pressure (Max. range) kgf/cm ² (KPa)	空氣 AIR 水 (常溫) Water	0~1 (0~10)			0~0.5 (0~5)
材質 Material	本體 Body	PTFE			
	膜片 Diaphragm	PTFE			
	彈簧 Spring	不銹鋼 Stainless steel			
重量 Weight	kg	0.58	0.57	0.65	1.8

註：本製品不適用於高溫液態，冷卻時為固態之流體，腐蝕性之流體及粘度超過 20CST 之流體。

Note : This product is not suitable for the liquid of high temperature, the fluid of solid while cooling and the fluid of corrosive and viscosity exceed 20CST

外觀圖形尺寸 External Dimensions

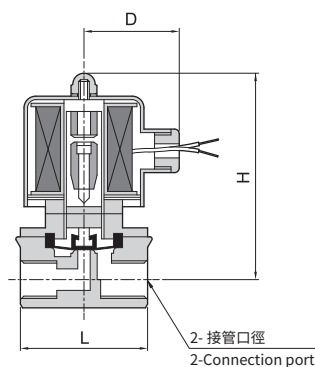

尺寸 Code / 機種 Model	SDC-8-TF	SDC-10-TF	SDC-15-TF	SDC-20-TF
D	48			
H	90		93	115
L	51		54	76

SUB 系列 電磁閥 - 二口二位氣控閥

SUB series - Two port and two way cylinder valve

規格表與訂購說明 Specification and How to Order

內部結構圖 Internal Structure

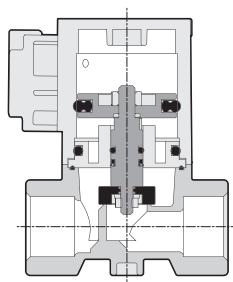

流體安裝說明
Valve Installation

正壓場合用
Positive Pressure



註：進氣源裝置
在 IN 端
Note: Inlet air
installed in IN side

規格表 Specification

項目 Item		機種 Model	SUB-8	SUB-10	SUB-15	SUB-20
使用流體 Fluid			空氣 Air			
使用溫度範圍 Ambient and fluid temperature °C			-10°C ~60°C			
閥位置數 Number of position ports			二口二位電磁閥 2 ports 2 positions solenoid valve			
作動方式 Operating mode			NC 常閉型 / NO 常開型 / 複動作式 NC Type / No Type / Double acting			
閥門切換方式 Valve operating method			空氣導引 Direct diaphragm type (Teflon niuemenon can able to bear the strong acid to use)			
氣缸引導壓力範圍 Cylinder pilot operating pressure range		Mpa	(NC 常閉型) 0.35~0.7 / (NO 常開型 & 複動作式) ※ 參閱使用說明 - 圖表 (1) NC Type / No Type & Double acting			
閥門洩漏 Valve leakage		cm ³	0.12 以下 0.12 Below			
連接口徑 Connection port (PT / PF / NPT)			1/4	3/8	1/2	3/4
節流孔徑 Orifice diameter mm Ø			10	10	15	16
使用壓力範圍 (最大範圍) kgf/cm ² (KPa) Rang of operating pressure (Max. range)			0~0.9 (0 ~ 900)		0~1 (0 ~ 1000)	
材質 Material	本體 Body		鍛造銅製品 Brass body		鑄造銅製品 Brass body	
	膜片 Diaphragm		NBR			
	彈簧 Spring		鋼琴線 Stainless steel			
重量 Weight kg			0.31	0.24	0.57	1.6

註：本製品不適用於高溫液態，冷卻時為固態之流體，腐蝕性之流體及粘度超過 20CST 之流體。

Note: This product is not suitable for the liquid of high temperature, the fluid of solid while cooling and the fluid of corrosive and viscosity exceed 20CST

訂購稱呼代號 How to Order

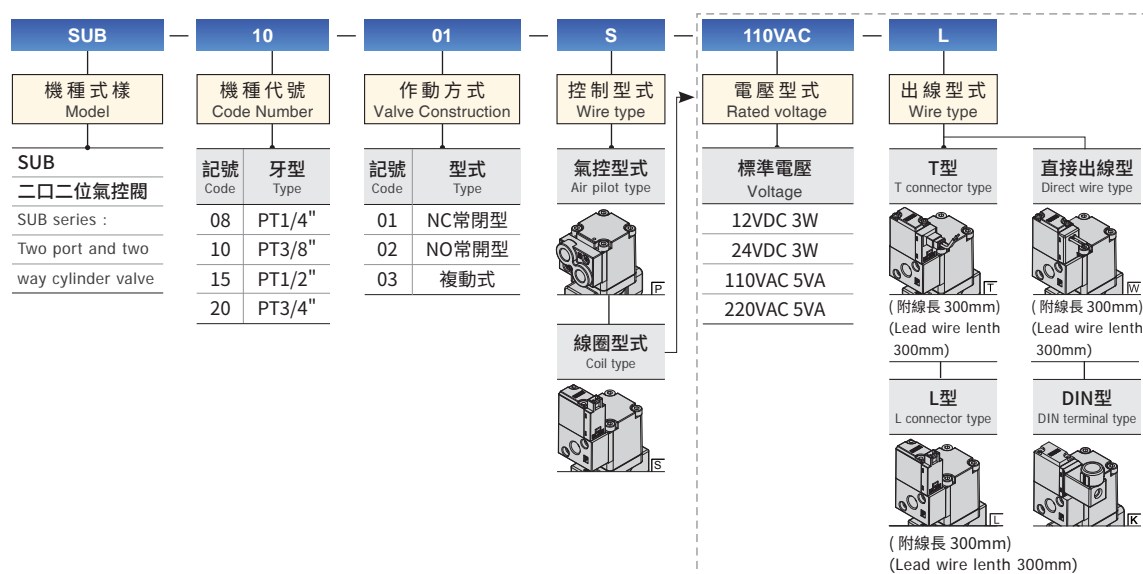

SUB 系列 電磁閥 - 二口二位氣控閥

SUB series - Two port and two way cylinder valve

內部結構圖與零件表 Internal Structure and Component Parts

內部結構圖 Internal Structure

● NC 二口二位置

NC Type

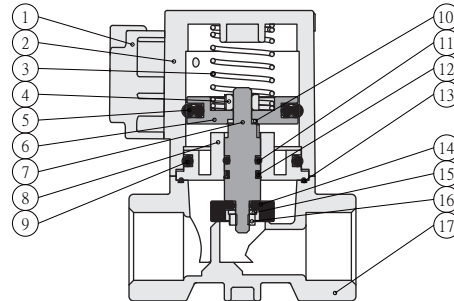
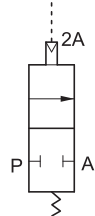

● NO 二口二位置

NO Type

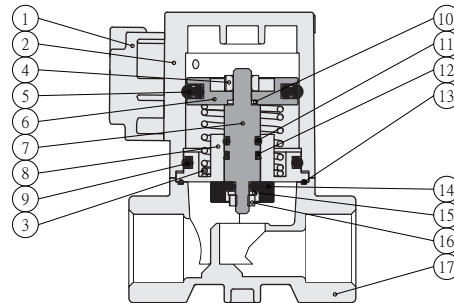
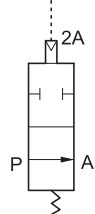

● 複動作 二口二位置

Double acting

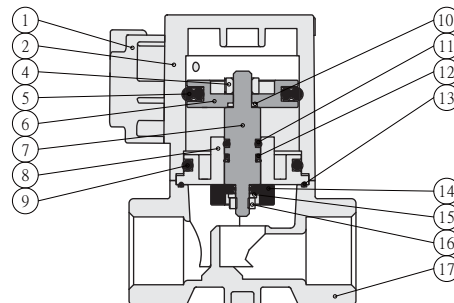
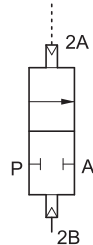

零件表 Component parts

編號 Item	項目 Description	材質 Material	編號 Item	項目 Description	材質 Material
01	接頭蓋 / 線圈蓋 Joint cover	鋁合金 Aluminum ally	09	O 型環 O-ring	耐油膠 NBR
02	本體 Body(upper)	鋁合金 Aluminum ally	10	O 型環 O-ring	耐油膠 NBR
03	NC 壓縮彈簧 / NO 壓縮彈簧 Spring	鋼琴線 Steel wire	11	O 型環 O-ring	耐油膠 NBR
04	螺帽 Nut	不鏽鋼 Stainless steel	12	O 型環 O-ring	耐油膠 NBR
05	PSD 迫緊 O-ring	耐油膠 NBR	13	O 型環 O-ring	耐油膠 NBR
06	活塞 Piston	鋁合金 Aluminum ally	14	閥門橡膠 Valve rubber	耐油膠 NBR
07	螺桿 Screw bolt	黃銅 Brass	15	螺帽彈簧華司 Nut spring washer	不鏽鋼 Stainless steel
08	隔板 Bulkhead	黃銅 Brass	16	本體座 Body(bottom)	鋁合金 Aluminum ally

SUB 系列 電磁閥 - 二口二位氣控閥

SUB series - Two port and two way cylinder valve

外觀圖形尺寸 / 氣控型 External Dimensions and Air Pilot Type

► SUB 8 & 10 系列 SERIES - [P]

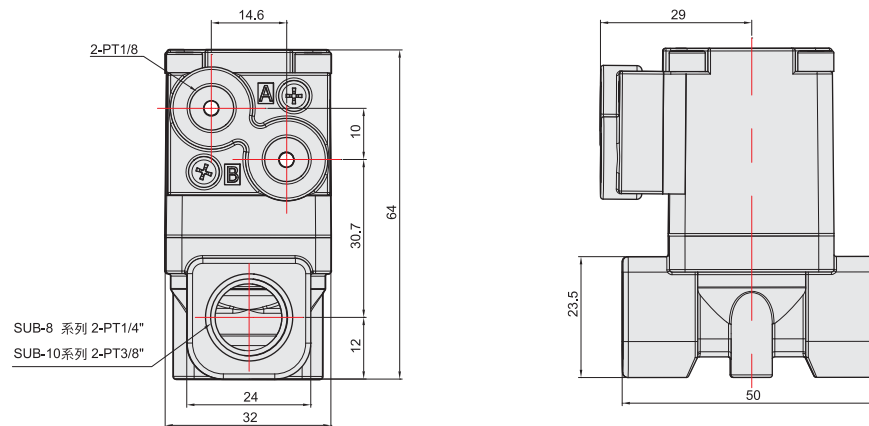

► SUB 15 系列 SERIES - [P]

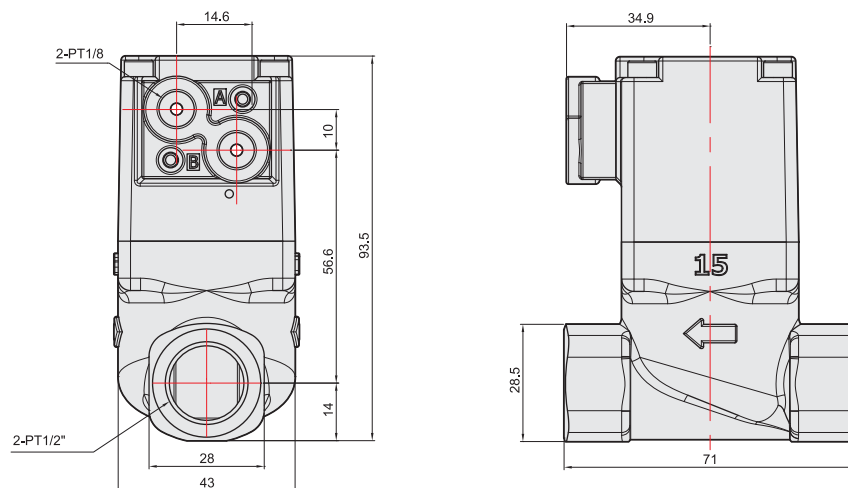

► SUB 20 系列 SERIES - [P]

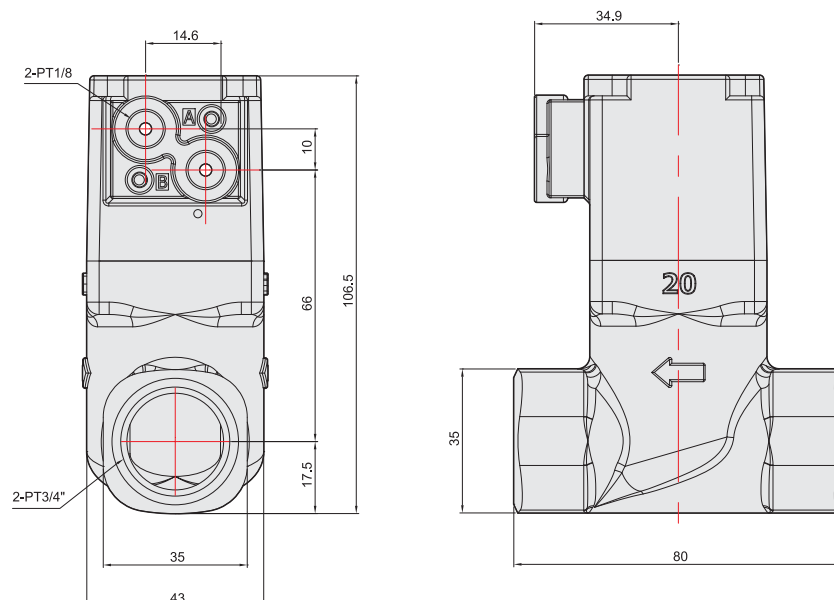

SBS
電磁閥

SU
電磁閥

SFW
電磁閥

SUD2
電磁閥

SUW2
電磁閥

SUS
電磁閥

SAS
電磁閥

SDC
電磁閥

SUB
氣控閥

SUG
氣控閥

SUB 系列 電磁閥 - 二口二位氣控閥

SUB series - Two port and two way cylinder valve

外觀圖形尺寸 / 線圈型 External Dimensions and Coil type

▶ SUB 8 & 10 系列 SERIES - -

● T型-

T connector type

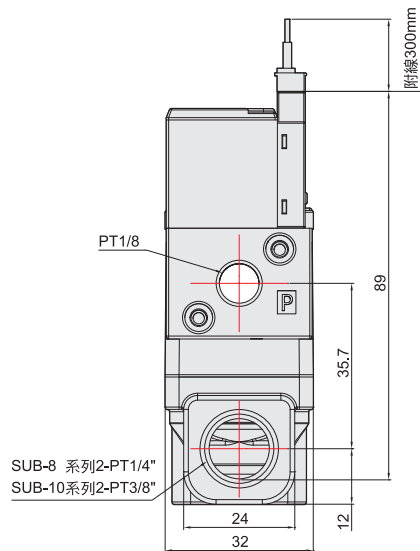

● L型-

L connector type

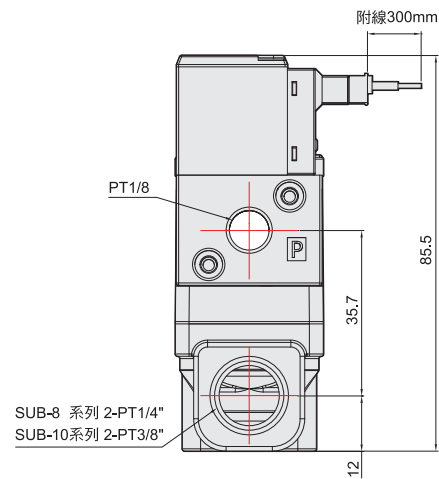

● 直接出線型-

Direct wire type

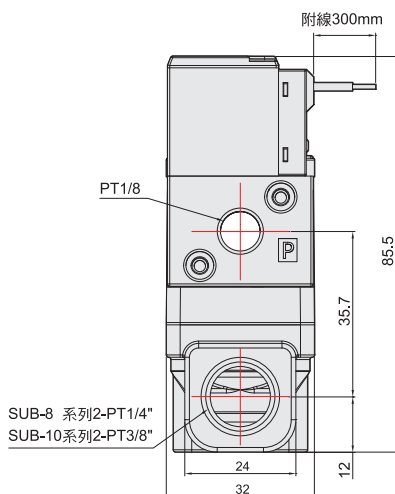

● DIN型-

DIN terminal type

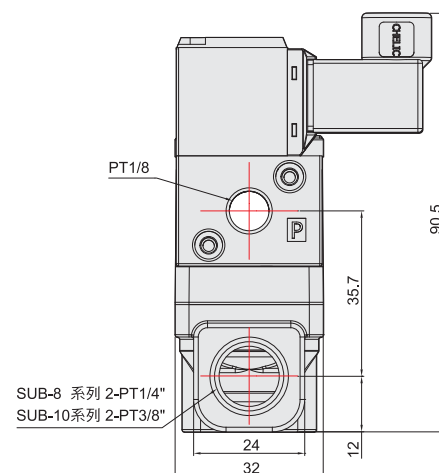

SUB 系列 電磁閥 - 二口二位氣控閥

SUB series - Two port and two way cylinder valve

外觀圖形尺寸 / 線圈型 External Dimensions and Coil type

▶ SUB 15 系列 SERIES - □ - □

● T型 - □
T connector type

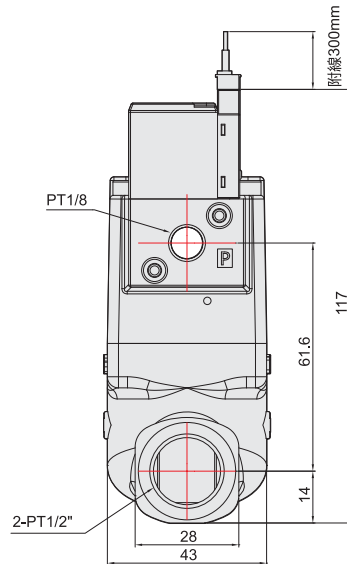

● L型 - □
L connector type

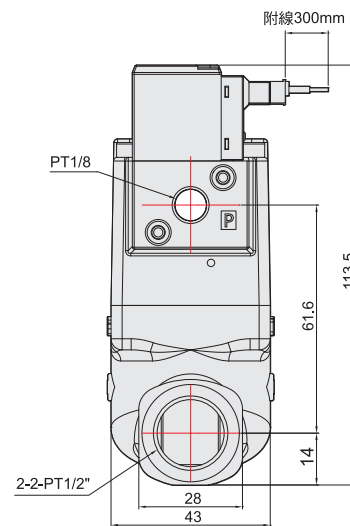

● 直接出線型 - □
Direct wire type

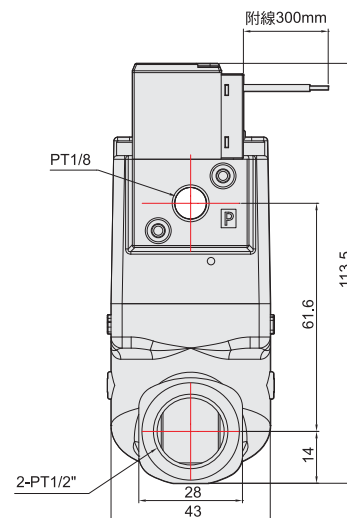

● DIN型 - □
DIN terminal type

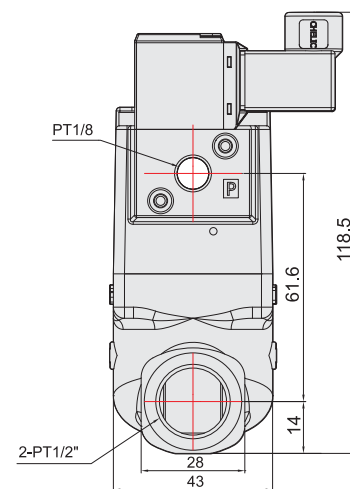

SBS
電磁閥

SU
電磁閥

SFW
電磁閥

SUD2
電磁閥

SUW2
電磁閥

SUS
電磁閥

SAS
電磁閥

SDC
電磁閥

SUB
氣控閥

SUG
氣控閥

SUB 系列 電磁閥 - 二口二位氣控閥

SUB series - Solenoid valve Direct operated (General)

外觀圖形尺寸 / 線圈型 External Dimensions and Coil type

► SUB 20 系列 SERIES - □ - □

● T型-□ T connector type

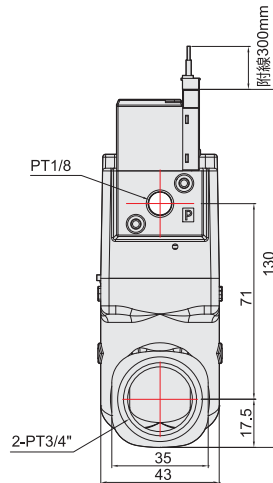

● L型-□ L connector type

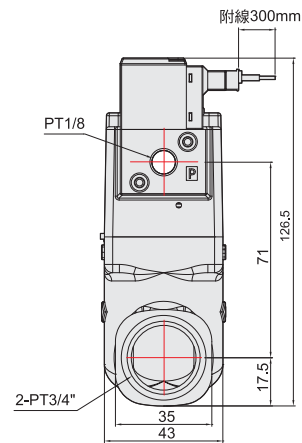

● 直接出線型-□ Direct wire type

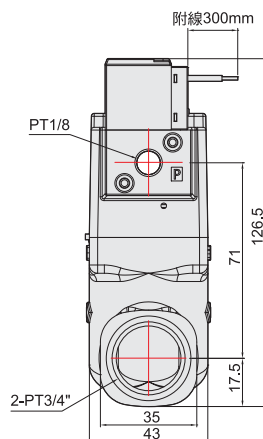

● DIN型-□ DIN terminal type

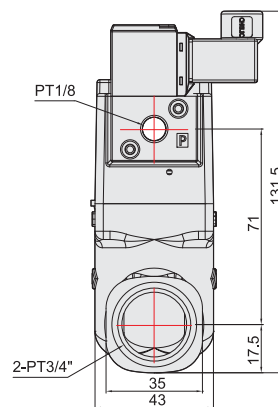

► 空氣引導壓力範圍 - (常開型 & 複動作式) Air pilot pressure range chart (No & double acting)

● 圖表(1)

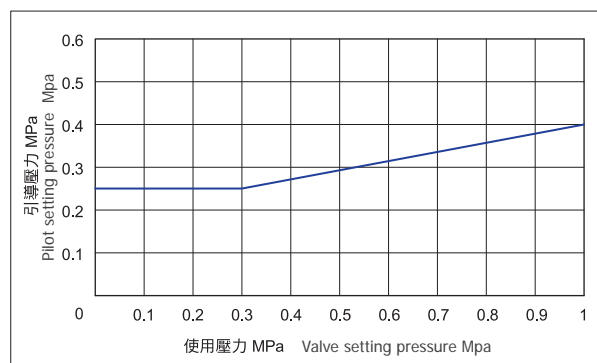

SUG 系列 電磁閥 - 二口二位氣控閥

SUG series - Two port and two way cylinder valve

規格表與訂購說明 Specification and How to Order

訂購稱呼代號 How to Order

SUG	25																
機種式樣 Series	接管口徑 Code Number																
SUG 二口二位氣控閥 SUG series : Two port and two way cylinder valve.	<table border="1"> <tr> <th>記號 Code</th><th>口徑 Type</th></tr> <tr> <td>10</td><td>1/4"</td></tr> <tr> <td>15</td><td>1/2"</td></tr> <tr> <td>20</td><td>3/4"</td></tr> <tr> <td>25</td><td>1"</td></tr> <tr> <td>35</td><td>1 1/4"</td></tr> <tr> <td>40</td><td>1 1/2"</td></tr> <tr> <td>50</td><td>2"</td></tr> </table>	記號 Code	口徑 Type	10	1/4"	15	1/2"	20	3/4"	25	1"	35	1 1/4"	40	1 1/2"	50	2"
記號 Code	口徑 Type																
10	1/4"																
15	1/2"																
20	3/4"																
25	1"																
35	1 1/4"																
40	1 1/2"																
50	2"																

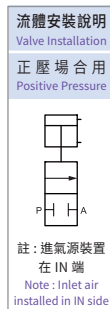

規格表 Specification

項目 Item	機種 Model	SUG-10	SUG-15	SUG-20	SUG-25	SUG-35	SUG-40	SUG-50
使用流體 Fluid		適用於空氣、水、油 Suitable for the fluid of air, water and oil						
使用溫度範圍 Range of service temperature	°C	-5 °C ~ 100 °C						
作動方式 valve construction		直動式 Direct operated poppet						
使用介質黏度 Applicable medium viscosity		50 CST 以下 Below 50CTS						
氣缸內徑 Cylinder bore size	mm	20	20	20	32	50	50	63
接管口徑 Port size		Rc 1/4"	Rc 1/2"	Rc 3/4"	Rc 1"	G1 1/4"	G1 1/2"	G 2"
節流孔徑 Orifice diameter	mm	16	16	20	25	35	40	50
有效斷面積 CV 值 CV value		4.8	4.8	12	7.6	24	29	48
使用壓力範圍 Rang of operating pressure kgf/cm ² (KPa)		0 ~ 7 (0~700)						
最大耐壓力 Withstand pressure kgf/cm ² (KPa)		10.5						
控制壓力範圍 Range of control pressure kgf/cm ² (KPa)		3~6						
材質 Material	本體 Body	黃銅製品 Brass						
	油封 Grease seal	鐵氟龍 PTFE						
控制接管口徑 Port size of control	(E)	2-M5	2-M5	2-M5	2-Rc1/8"	2-Rc1/4"	2-Rc1/4"	2-Rc1/4"

註：本製品不適用於高溫液態，冷卻時為固態之流體，腐蝕性之流體及粘度超過 20CST 之流體。

Note: This product is not suitable for the liquid of high temperature, the fluid of solid while cooling and the fluid of corrosive and viscosity exceed 20CST

外觀圖形尺寸 External Dimensions

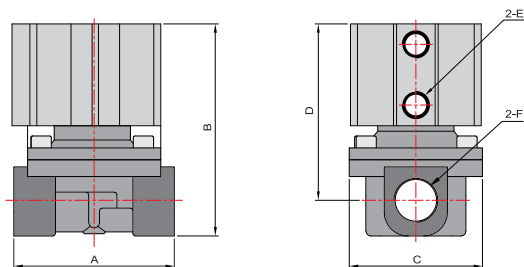

型號 Model	A	B	C	D	E	F
SUG-10	66	83	57	70.5	M5	Rc 1/4"
SUG-15	66	83	57	70.5	M5	Rc 1/2"
SUG-20	92	108	78	87.5	M5	Rc 3/4"
SUG-25	92	108	78	87.5	Rc 1/4"	Rc 1"
SUG-35	125	125	95	100.5	Rc 1/4"	G 1 1/4"
SUG-40	125	131	95	100.5	Rc 1/4"	G 1 1/2"
SUG-50	168	152	125	117	Rc 1/4"	G 2"

SBS
電磁閥SU
電磁閥SFW
電磁閥SUD2
電磁閥SUW2
電磁閥SUS
電磁閥SAS
電磁閥SDC
電磁閥SUB
氣控閥SUG
氣控閥

台灣 / 台灣氣立股份有限公司 TAIWAN CHELIC Co., Ltd.

台灣 TAIWAN

台北 台北總公司 / 新北市泰山區貴鳳街21號
Taipei No.21, Guifeng St., Taishan Dist., New Taipei City 243, Taiwan
Tel : + 886 - 2 - 2904 - 1235 (代表號)
Fax : + 886 - 2 - 2904 - 1706
E-mail : chelic@chelic.com

桃園 桃園分公司 / 桃園縣中壢市正光二街122號
Taoyuan No.122, Zhengguang 2nd St., Zhongli Dist., Taoyuan City 320, Taiwan
Tel : + 886 - 3 - 4029 - 001 (代表號)
Fax : + 886 - 3 - 4029 - 005

新竹 新竹特約經銷商 (吉祥) / 新竹縣竹北市福興路875號1樓
Hsinchu No.857, Fuxing Rd., Zhubei City, Hsinchu County 302, Taiwan
Tel : + 886 - 3 - 5586 - 085 (代表號)
Fax : + 886 - 3 - 5588 - 904

台中 台中分公司 / 台中市西區精誠十六街16號
Taichung No.16, Jingcheng 16th St., West Dist., Taichung City 403, Taiwan
Tel : + 886 - 4 - 2320 - 5828 (代表號)
Fax : + 886 - 4 - 2320 - 6118

高雄 高雄特約經銷商 (行信行) / 高雄市仁武區水管路三段90號
Kaohsiung No.90, Sec. 3, Shuiguan Rd., Renwu Dist., Kaohsiung City 814, Taiwan
Tel : + 886 - 7 - 3755 - 850 (代表號)
Fax : + 886 - 7 - 3756 - 850

大陸 / 深圳氣立可氣動設備有限公司 SHENZHEN CHELIC PNEUMATIC Co.

華南地區 SOUTH CHINA

深圳 深圳市光明新區上村社區蓮塘工業城B區第12棟3樓B區 (恒壽科技大廈)
Shenzhen 3RD, Floor B Block, The 12th Building, B Street Shangcun Liantang Industry Gongming Town, New Guangming District, Shenzhen City, Guangdong Province.
Tel : + 86 - 755 - 3369 - 9188 (代表號)
Fax : + 86 - 755 - 3369 - 9112, 3369 - 9113
E-mail : szx@chelic.com

龍華 深圳市龍華新區油松路106號天匯大廈B棟530室
Longhua Room 530, No B Tianhui building, No106 Yousong Road, New Longhua District, Shenzhen City.
Tel : + 86 - 755 - 2940 - 6509, 2941 - 6477
Fax : + 86 - 755 - 2376 - 3631

坪山 廣東省深圳市龍崗區坪山鎮泰富華庭2號C單元408室
Pingshan Room 408, Unit C, No 2, Taifu Garden, Pingshan Town, Longgang District, Shenzhen City, Guangdong Province.
Tel : + 86 - 755 - 8460 - 4856, 8460 - 4857
Fax : + 86 - 755 - 8460 - 4860

珠海 廣東省珠海市香洲區南屏山橋路華策南灣國際三棟一單元1304室
Zhuhai Room 1304, Unit 1, No 3 building, Huace South Bay International, No 133 Maofeng Road, Xiangzhou District, Zhuhai City, Guangdong Province.
Tel : + 86 - 756 - 8676 - 271
Fax : + 86 - 756 - 8676 - 272

佛山 廣東省佛山市禪城區嶺南大道北(東江國際)A區1座707室
Foshan Room 707, No 1 Building, A Area, Dongjiang International, North side of Lingnan Avenue, Chancheng District, Foshan City, Guangdong Province.
Tel : + 86 - 757 - 8307 - 5867, 8307 - 3501
Fax : + 86 - 757 - 8307 - 2762

福州 福州市倉山區浦上大道正祥一品新築2棟304號
Fuzhou Room 304, No 2 building, New Zhengxiang Garden, Pushang Avenue, Cangshan District, Fuzhou City, Fujian Province.
Tel : + 86 - 591 - 8376 - 7959, 8639 - 1869
Fax : + 86 - 591 - 8305 - 9559

廈門 福建省廈門市集美區樂海北里222號1101室
Xiamen Room 1101, No222, North Lehai Area, Jimei District, Xiamen City, Fujian Province.
Tel : + 86 - 592 - 6104 - 307, 6242 - 217
Fax : + 86 - 592 - 6104 - 737

東莞 東莞市東城區東莞大道17號匯業大廈15樓06號
Dongguan No.6, F15, Huiye Building, No17 Dongguan Avenue, East Area of Dongguan City, Guangdong Province.
Tel : + 86 - 769 - 2315 - 2110, 2868 - 9123
Fax : + 86 - 769 - 2638 - 0925

常平 東莞市常平鎮橫江廈管理區麗景國際綠華庭1棟1501室
Changping Room 1501, No.1 Lijing International Garden, Hengjiang Building Management, Changping Town, Dongguan City, Guangdong Province.
Tel : + 86 - 769 - 2315 - 2110, 2868 - 9123
Fax : + 86 - 769 - 2638 - 0925

廣州 廣東省廣州市海珠區暉悅三街10號25棟606室 (保利天悅花園)
Guangzhou Room 606, No 25 Building, No 10 Huiyue 3rd Road, Haizhu District, Guangzhou City, Guangdong Province.
Tel : + 86 - 20 - 8923 - 6762, 8923 - 6615
Fax : + 86 - 20 - 3424 - 8180

長沙 長沙市雨花區長沙大道雨花館1棟301室
Changsha Room 301, No 1 Building, Yuhua Garden, Changsha Avenue, Yuhua District, Changsha City, Hunan Province.
Tel : + 86 - 731 - 8803 - 8255
Fax : + 86 - 731 - 8829 - 8270



www.chelic.com

大陸 / 上海氣立可氣動設備有限公司 SHANGHAI CHELIC PNEUMATIC Co.

上海地區

SHANGHAI CITY

上海 上海市松江區新橋鎮曹農路467號
Shanghai No.467 Caonong Road,Xinqiao Town,Songjiang District, Shanghai
Tel : + 86 - 21 - 6025 - 1288 (代表號)
Fax : + 86 - 21 - 6025 - 1265 , 6025 - 1266
E-mail : sha@chelic.com

浦東 上海市浦東新區川沙鎮華夏二路201弄13幢32號302室
Pudong Room 302, No.13 Building HuaxiaRoad,Chuansha Town,
Pudong New Area,Shanghai
Tel : + 86 - 21 - 6025 - 1288(代表號)
Fax : + 86 - 21 - 6025 - 1265

浙江地區

ZHEJIANG PROVINCE

溫州 溫州市甌海區三洋街道黃嶼家園3幢503室
Wenzhou Room 503, No 3 building, Huangyu Garden Sanyang Street
Ouhai District,Wenzhou City,Zhejiang Province.
Tel : + 86 - 577 - 8855 - 8301
Fax : + 86 - 577 - 8855 - 8317

杭州 杭州市蕭山區北干街道綠都世貿廣場E座1603室
Hangzhou Room 1603, Hall E,Lvdu Shimao Square, Beigan Street, Xiaoshan
District,Hangzhou City,Zhejiang Province
Tel : + 86 - 571 - 8721 - 4160
Fax : + 86 - 571 - 8721 - 4170

寧波 寧波市江東高新區江南路646號江南一品305號1526室
Ningbo Room 1526, No 305 Jiangnan Yipin,No.646 Jiangnan Road,
High-tech Zoon,Ningbo City,Zhejiang Province.
Tel : + 86 - 574 - 8303 - 3290
Fax : + 86 - 574 - 8303 - 3293

嘉興 浙江省嘉興市秀洲區吳越路158號華新花園3幢101室
Jiaxin Room 101, No 3 building, HuaXin Garden,No.158 Wuyue Road,
Xiuzhou District,Jiaxin City,Zhejiang Province.
Tel : + 86 - 573 - 8281 - 3237
Fax : + 86 - 573 - 8255 - 3109

華東地區

EAST CHINA

蘇州 江蘇省蘇州市姑蘇區萬達廣場9棟1201室
Suzhou Room 1201, Unit 9, Wanda Plaza, Gusu District, Suzhou City,
Jiangsu Province.
Tel : + 86 - 512 - 6935 - 7901 , 6935 - 7902
Fax : + 86 - 512 - 6935 - 7906

昆山 江蘇省昆山市玉山鎮柏廬南路89號世茂蝶湖灣花園
Kunshan 15號樓1單元901室
Room 901, Unit 1, No 15 building, Shimao butterfly, No.89 South Bolu Road,
Yushan Town,Kunshan City,Jiangsu Province.
Tel : + 86 - 512 - 5786 - 5636 , 5786 - 8569
Fax : + 86 - 512 - 5762 - 0755

南京 南京市秦淮區龍蟠中路399號東城水岸2棟B單元1204
Nanjing Room 1204, Unit B, No 2 building, Dongchengshui, No 399 Middle Dongfan
Road,Qinhuai District,Nanjing City,Jiangsu Province.
Tel : + 86 - 25 - 8468 - 0732
Fax : + 86 - 25 - 8468 - 0673

常州 江蘇省常州市新北區嵩山路9號515室
Changzhou Room 515, No.9 Songshan Road, North New District,
Changzhou City,Jiangsu Province.
Tel : + 86 - 519 - 8169 - 3558
Fax : + 86 - 519 - 8526 - 9930

無錫 無錫市新區長江路12號長江大廈5-1901
Wuxi Room 5-1901, No 12 Changjiang Building, New District, Wuxi City,
Jiangsu Province.
Tel : + 86 - 510 - 6690 - 5571
Fax : + 86 - 510 - 6690 - 5572

合肥 安徽省合肥市太湖東路111號新裡海頓公館三期C6幢503室
Anhui Room 503, No C6 building, New Rihton Masion, No 111 ,
EastTaihu Road,Hefei City, Anhui Province.
Tel : + 86 - 551 - 6381 - 0040
Fax : + 86 - 551 - 6381 - 0020

西北地區

NORTHWEST AREA

西安 陝西省西安市高新區紫薇田園都市D區1號樓1單元11004室
Xian Room 1104, Unit 1, No 7 building, D zoon, Ziwei Garden,
High-Tech Zoon,Xian City,Shanxi Province.
Tel : + 86 - 29 - 8817 - 2570
Fax : + 86 - 29 - 8817 - 2571

成都 成都市金牛區恆大西錦城4棟2單元0904室
Chengdu Room 0904, Unit 2, No.4 building, West Hengda Garden,
Jinniu District, Chengdu City, Sichuan Province.
Tel : + 86 - 28 - 8317 - 5589
Fax : + 86 - 28 - 8778 - 7387

重慶 重慶特約經銷商 (重慶松可科技有限公司)
Chongqing 重慶市九龍坡區石橋鋪科園一路2號大西洋國際大廈21-5
Room 21-5, Atlantic International Building , No 2, First Keyuan
Road,Longpo District,Chongqing City.
Tel : + 86 - 23 - 6868 - 1859 , 6868 - 1869
Fax : + 86 - 23 - 6868 - 1879

鄭州 鄭州市航空港區鄭港4路鄭報潤園二期7-2-1202
Zhengzhou Room 2-1202, No 7 Building, Zhengbaorun Garden, Zhenggang Road ,
Hangkong port District, Zhengzhou City, Henan Province.
Tel : + 86 - 371 - 5598 - 7146
Fax : + 86 - 371 - 5598 - 7145

武漢 武漢市洪山區關山大道，長城坐標城A4-4-502室
Wuhan Room 4-502, No A4 building, Great Wall Coodinate City,
Guanshan Avenue, Hongshan District,Wuhan City, Hubei Province.
Tel : + 86 - 27 - 8761 - 4322 , 8761 - 5322
Fax : + 86 - 27 - 8761 - 4922

華北地區

NORTH CHINA

濟南 濟南市高新區世紀大道15612號(理想嘉園)2號樓1-708
Jinan Room 1-708, No 2 building, Lixiang Garden, No 15612 Century
Avenue, High-tech Zoon,Jinan City, Shandong Province.
Tel : + 86 - 531 - 6780 - 6393
Fax : + 86 - 531 - 6780 - 5983

天津 天津市西青區東方環球影城B座912室
TianJin Room 912, B block, Oriental universal studios, Xiqing District, TianJin
Tel : + 86 - 22 - 8672 - 8129
Fax : + 86 - 22 - 8672 - 8139

青島 青島市城陽區文陽路世紀民生小區7號樓1單元202室
Qindao Room 202, Unit 1, No.7 Building, Century Minsheng Community,
Wenyang Road, Chengyang District, Qindao City, Shandong Province.
Tel : + 86 - 532 - 8765 - 2491
Fax : + 86 - 532 - 8765 - 2406

瀋陽 瀋陽市沈河區西濱河路58號，未來城 3-24-2
Shenyang No.24-2, No 58 building, furture town, West Binhe Road,
Shenhe District, Shenyang City, Liaoning Province.
Tel : + 86 - 024 - 8101 - 9810
Fax : + 86 - 024 - 8101 - 9860

煙臺 山東省煙臺市開發區長江路160號星頤廣場7號塔樓1816室
Yantai Room 1816, 7 Building, Xingyi Square No.160 Changjiang
Development District,Yantai City,Shandong Province.
Tel : + 86 - 053 - 5638 - 1260
Fax : + 86 - 053 - 5638 - 1260
E-mail : cheliccynt@chelic.com

可使用流體識別圖 Used of fluid identification items



Air

空氣



Medium Vacuum

真空



Oil

輕油



Steam

蒸氣



Water

水



台灣氣立公司

■ 台灣氣立股份有限公司 TAIWAN CHELIC Co., Ltd.

總公司／新北市泰山區貴鳳街21號

No.21, Guifeng St., Taishan Dist., New Taipei City 243, Taiwan

TEL: +886-2-2904-1235(代表號)

FAX: +886-2-2904-1706

E-mail: chelic@chelic.com



上海氣立可公司

■ 上海氣立可氣動設備有限公司 SHANGHAI CHELIC PNEUMATIC Co.

上海市松江區新橋鎮曹農路467號

No.467 Caonong Road, Xinqiao Town,
Songjiang District, Shanghai

TEL: +86-21-6025-1288(代表號)

FAX: +86-21-6025-1265

E-mail: sha@chelic.com



深圳氣立可公司

■ 深圳氣立可氣動設備有限公司 SHENZHEN CHELIC PNEUMATIC Co.

深圳市光明新區上村社區蓮塘工業城B區

第12棟3樓B區(恆壽科技大樓)

3RD, Floor B Block, The 12th Building, B Street Shangcun
Liantang Industry Gongming Town, New Guangming District,
Shenzhen City, Guangdong Province .

TEL: +86-755-3369-9188(代表號)

FAX: +86-755-3369-9112

E-mail: szx@chelic.com

本公司有保留變更規格之權利，恕不另行通知，請與業務單位保持聯繫，以便更新版本。

The specification are subject to change without advance notice.